

# FLUANCE®

## Ai61 - Powered 6.5" Bookshelf Speakers Manual v1.2



Serious Performance™

[Fluance.com](http://Fluance.com)

## Table Of Contents

Introduction .....	3
Break-in Period .....	3
Online Resources .....	3
What's Included .....	4
Front & Back Panel Layout .....	5
Remote Control Layout .....	6
Product Setup .....	7
Turning On/Off Unit .....	8
Source Selection .....	8
RCA Input .....	9
Bluetooth® Pairing .....	10
Optical Input .....	11
USB Input .....	12
Subwoofer Output .....	13
Volume Adjustment .....	14
EQ Adjustment .....	14
Adjusting Source LED Brightness .....	14
Frequently Asked Questions .....	15
Troubleshooting .....	16
Specifications .....	17
Certification Information .....	18
Warranty Information .....	19

## Introduction

Thank you for your purchase of your Fluance product. We hope you enjoy your experience. If you have any questions please visit us at:

[Fluance.com/support](https://fluance.com/support)

Fluance believes everyone should experience audio in its truest form, recreating the performance the way the artist intended. Utilizing only superior components and expert audio engineering, their products are a testament to the performance that can be achieved when a passion for music takes center stage. The perfect complement to any audiophile's lifestyle, you'll be enjoying live performances in your home for years to come.

## Break-in Period

Our speakers have a Butyl rubber ring surrounding the cone. The break-in period allows the rubber to loosen and stretch, allowing the cone a larger range of movement, resulting in better sound reproduction. We recommend 10-12 hours of play at moderate volume to achieve this.

## Online Resources

For videos on the full setup and configuration of your speakers visit us at:

[Fluance.com/resources](https://fluance.com/resources)

What's Included

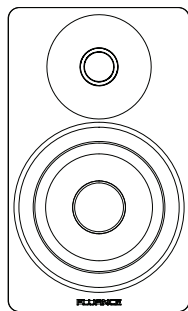

Ai61 Passive  
Speaker  
(Left Channel)

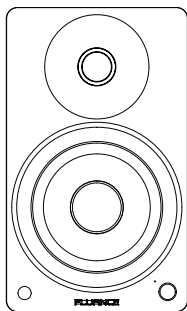

Ai61 Active  
Speaker  
(Right Channel)

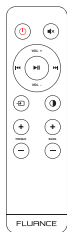

Remote  
Control



2x AAA  
Batteries

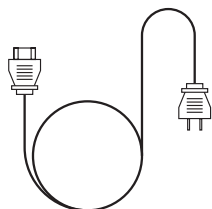

Power  
Cable



Speaker  
Wire

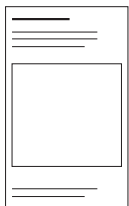

Quick Start  
Guide



Lifetime  
Customer Support

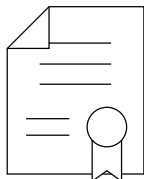

2 Year  
Warranty

## Front & Back Panel Layout

### Active Speaker - Front

1. Control Knob
  - Volume
  - Input Selection
  - Power ON/OFF
2. Source LED
  - Blue (Solid) - Bluetooth® Paired
  - Blue (Flashing) - Bluetooth® Pairing Mode
  - Green (Solid) - RCA
  - White (Solid) - Optical
  - Purple (Solid) - USB
  - Red (Solid) - Standby Mode
  - Red (Flashing) - Mute
  - Red (Flash x2) - Volume Set to Max
  - Red (Flash x2) - Bass/Treb Set to -5 or +5
  - Source Color: Blue/Green/White/Purple (Flash x2) - Bass/Treb Set to 0
3. IR Sensor

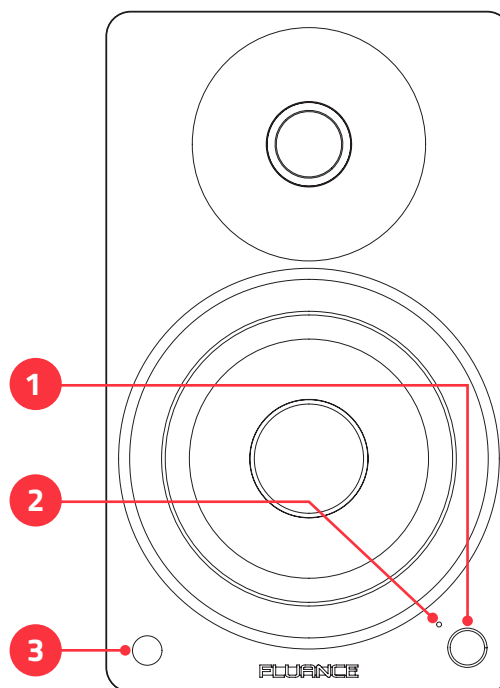

### Active Speaker - Back

4. Bluetooth® Reset Pairing
5. USB Input (Audio Playback Only)
6. Optical Input
7. RCA Input
8. Subwoofer Output
9. Left Speaker Output
10. DC Input
11. Power Switch

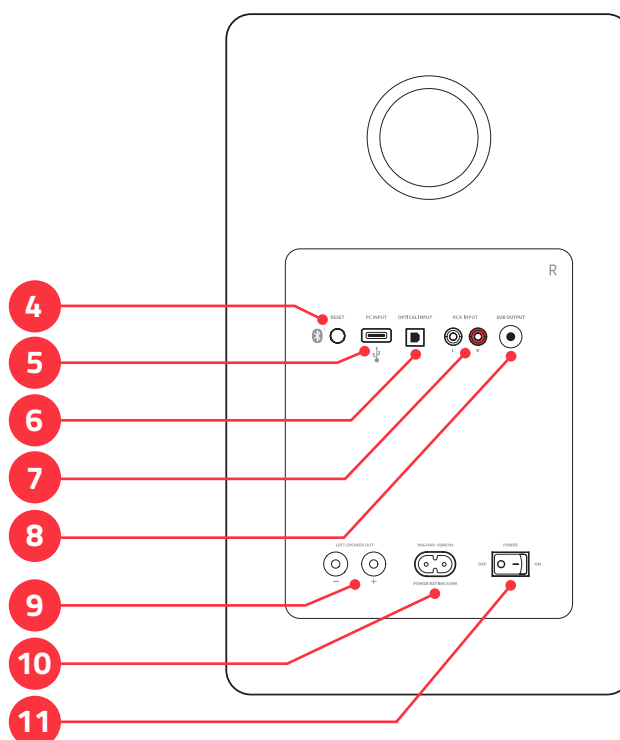

## Passive Speaker - Back

### 12. Speaker Input

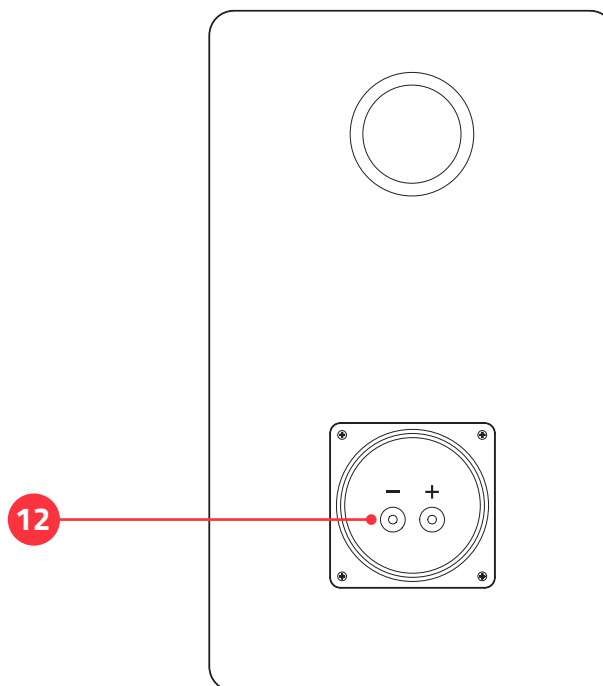

## Remote Control Layout

1. Power ON/OFF
2. Volume UP/DOWN
3. Source
4. Treble UP/DOWN
5. Mute
6. Play/Pause & Bluetooth Pairing Reset\*  
*\*To enable Bluetooth Pairing Reset, press + hold for 3 seconds.*
7. Forward/Back
8. LED Brightness - (100% > 25% > OFF)
9. Bass UP/DOWN

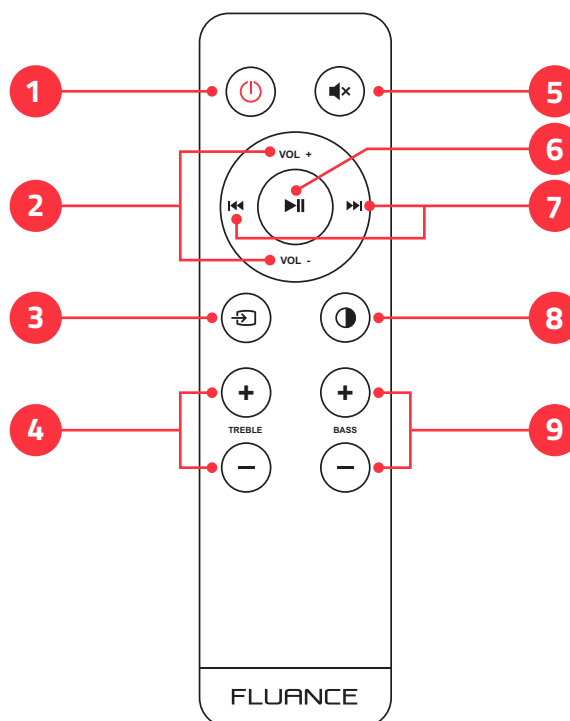

## Product Setup

1. Position the speakers with the Active Speaker on the right and the Passive Speaker on the left.

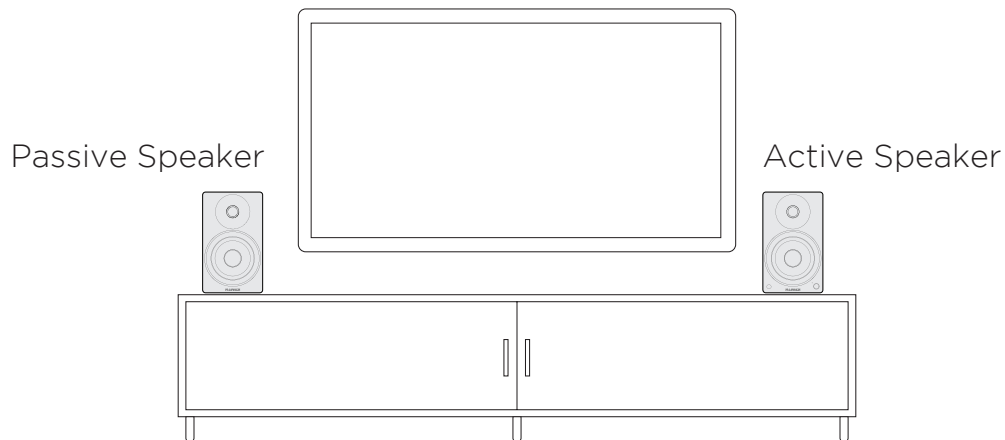

NOTE: If placing the speakers in a cabinet or on a shelf, position the front of the speakers as close as possible to the front edge of the shelf for optimum audio performance.

2. Connect one end of the speaker wire to the binding posts on the back of the Active Speaker and connect the other end of speaker wire to the binding posts on the back of the Passive Speaker.

*IMPORTANT: Ensure the same color wire is connected to the same color binding posts on each speaker.*

NOTE: The included speaker wire is 8ft. If placing your speakers further than 8ft apart it is recommended to use standard 18 gauge speaker wire to connect the speakers over the longer distance.

3. Connect the power adapter to the back of the Active Speaker and set the power switch to the ON position.

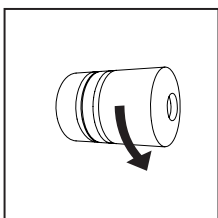

Loosen the binding post

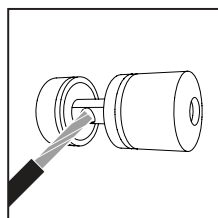

Insert speaker wire through hole

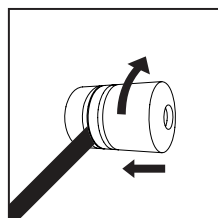

Tighten the binding post

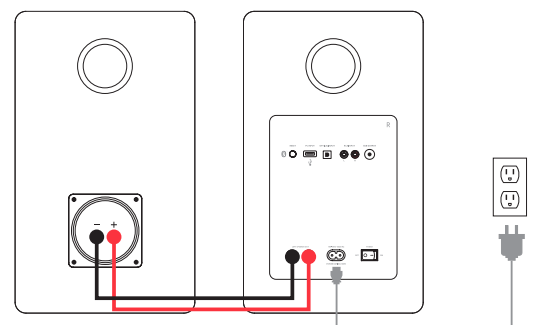

## Turning On/Off Unit

Press the Control Knob to turn on the unit. Hold to turn off the unit.

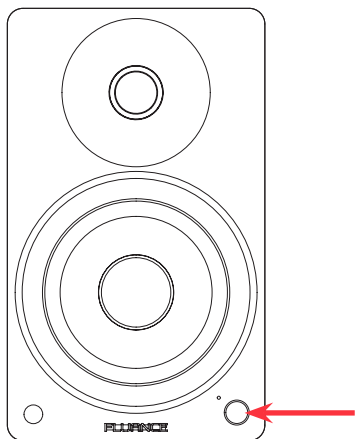

OR

Press  on the Remote to turn the unit on/off.

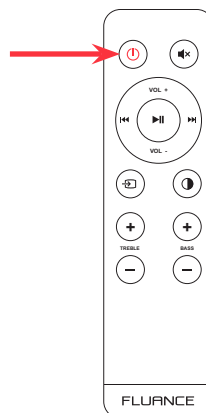

## Source Selection

Press the Control Knob to cycle through the audio inputs.

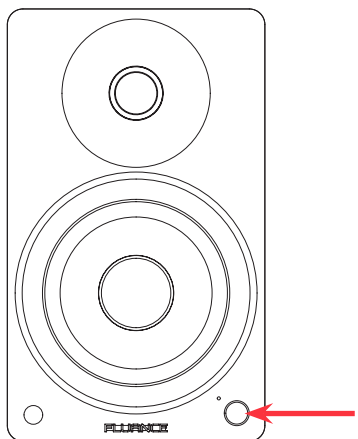

OR

Press  on the remote to cycle through the audio inputs.

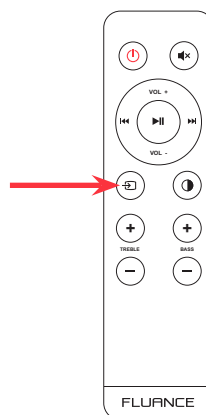

The Source LED will show the below color for each source:



(Blue) Bluetooth



(White) Optical



(Green) RCA



(Purple) USB



## RCA Input

1. Connect the RCA cable to your source device (Turntable, Smartphone, Computer...).
2. Connect the other end of the RCA cable to back of the Active Speaker.

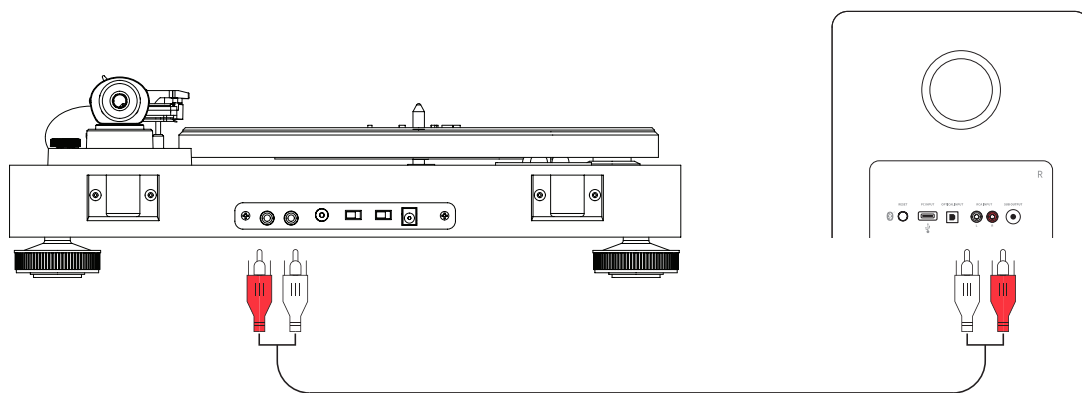

*\*RCA to RCA cable not included*

3. Press the Control Knob to select the RCA input (Green LED).
4. Adjust volume on Ai61 as well as source device.

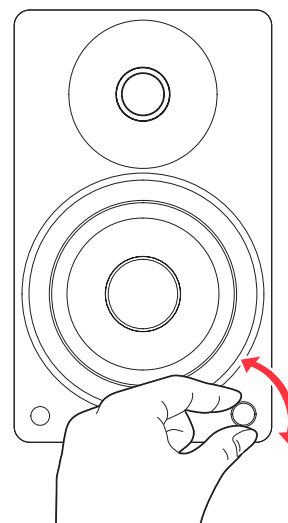
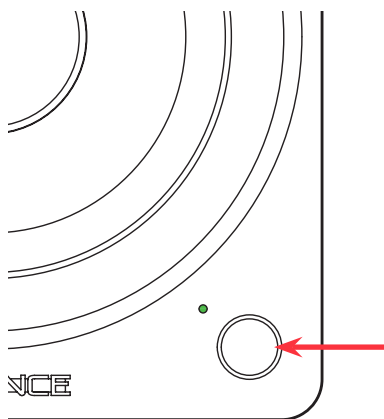

NOTE: When connecting a turntable to the Ai61, a phono preamplifier (preamp) must be used. Some turntables include a built-in preamp but others, without one, would require an external preamp.

Visit [Fluance.com](https://fluance.com) for more information on our phono preamplifier, the PA10.

## Bluetooth® Pairing

1. Press the Control Knob to select the Bluetooth input (Blue LED).
2. Pair to “Fluance Ai61” on your source device.

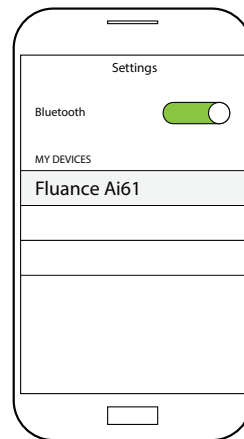
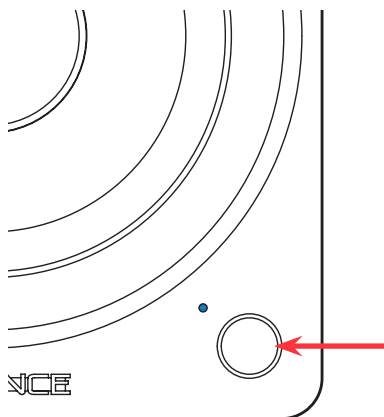

NOTE: Unit will attempt to auto-pair to the last paired device.

3. Use the Remote to control playback on your source device.

NOTE: Adjust Volume on the source device as well as the Ai61.



NOTE: How you access your device's Bluetooth settings may vary from one manufacturer to another. Maximum line of sight for Bluetooth range is 33ft. Obstacles may decrease transmission distance.

4. If your device cannot find “Fluance Ai61”, you can reset Bluetooth pairing:

- Press and hold **▶||** for 3 seconds to reset Bluetooth pairing.

**OR**

- Press the Bluetooth Pairing Reset Button on the back of the unit.

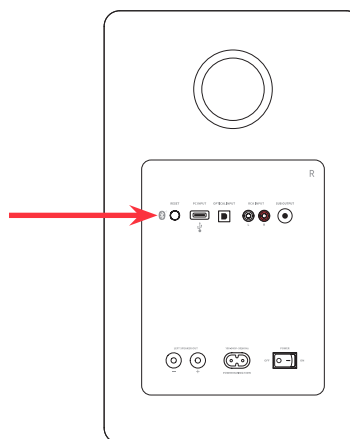

## Optical Input

1. Connect the Optical cable to your source device (TV, Computer, Game Console...). Ensure protective caps are removed from the ends of the Optical cable.
2. Connect the other end of the Optical cable to the back of the Active Speaker.

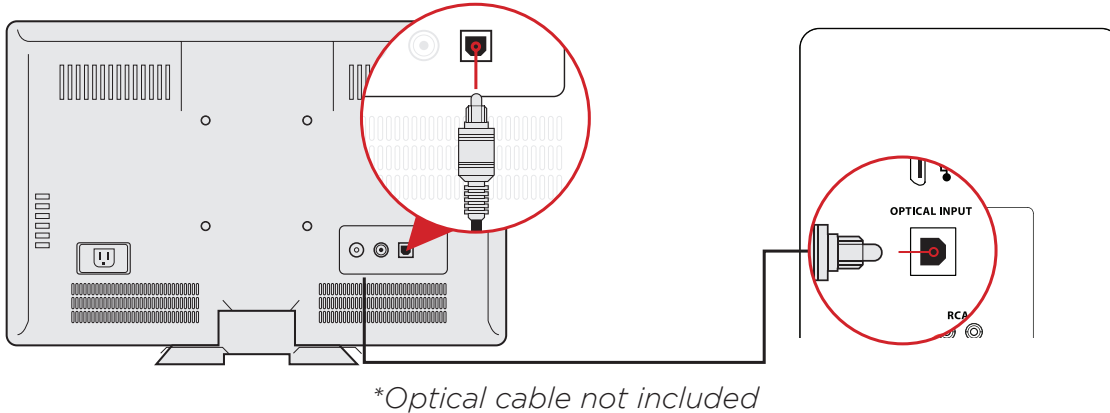

3. Press the Control Knob to select the Optical Input (White LED).
4. Adjust the volume on Ai61 as well as source device.

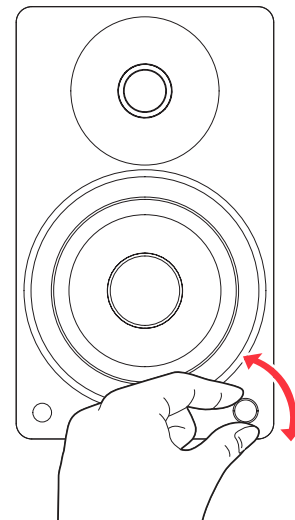
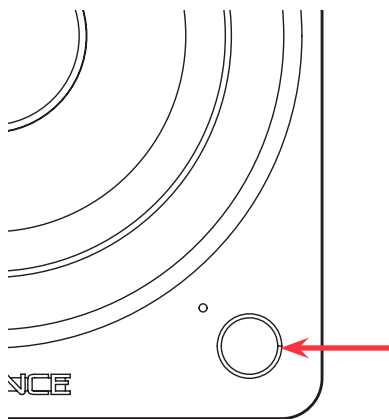

## Optical Audio Signal Compatibility

The Ai61 does not support Dolby Digital Audio or DTS Audio. Locate the audio output settings on your source device and ensure Dolby Digital is turned off. The correct audio output setting is commonly referred to as PCM or Stereo.

Some TVs also require that audio output be enabled. This setting may be referred to as External Speakers. Ensure this is selected as your speaker/audio output.

For instructions on a specific device, please consult the device's user manual.

## USB Input

1. Connect the USB cable to your source device (Laptop, Desktop...).
2. Connect the other end of the USB cable to USB-C port on the back of the Active Speaker.

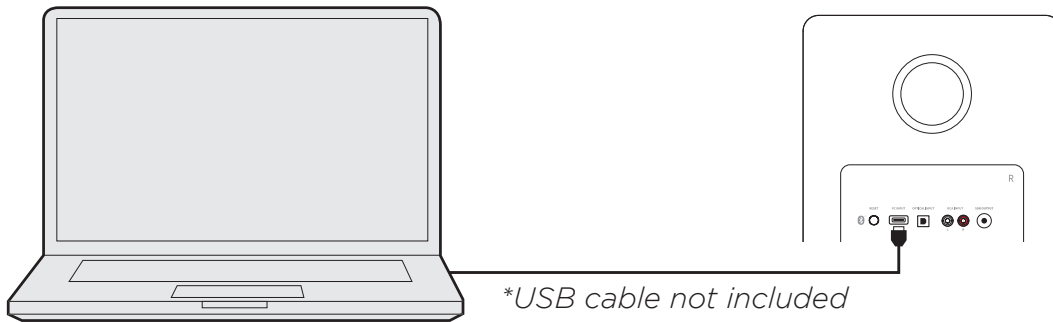

*IMPORTANT: The USB input on the Ai61 is for USB audio playback and not for USB charging.*

3. Press the Control Knob to select the USB input (Purple LED).
4. Adjust volume on Ai61 as well as source device. You may also need to adjust volume in the different programs on the source device.

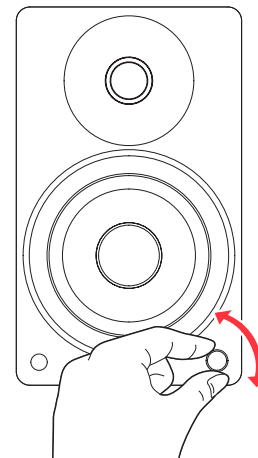
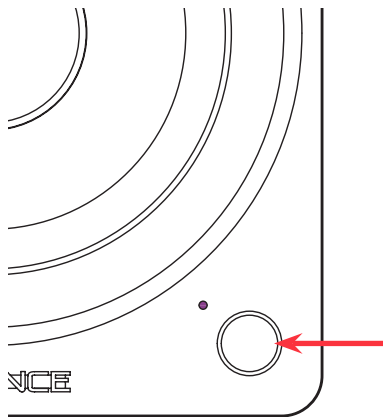

## USB Audio Output Settings

You may need to enable USB audio output on your source device. Here are the directions for most Windows® and Apple® Computers.

Windows®: Control Panel > Sound > USB Audio

Apple®: System Preferences > Sound > Output > USB

It is also important to check that any sound enhancements, effects, or EQ settings are disabled on your source device.

## Subwoofer Output

*IMPORTANT: When a subwoofer cable is connected, the Ai61 will automatically cut frequencies below 80Hz to optimize performance. The subwoofer cable must be removed to resume full frequency playback.*

1. Connect the Subwoofer cable to your powered subwoofer.
2. Connect the other end of the Subwoofer cable to the back of the Active Speaker.
3. Adjust the volume on the Subwoofer for the best listening experience.



*\*Subwoofer cable not included*

Fluance offers matching subwoofers for the ultimate audio experience.  
For more information visit:

[Fluance.com/subwoofer](https://fluance.com/subwoofer)





## Volume Adjustment

Turn the Control Knob or use the Remote to increase or decrease volume.

## EQ Adjustment

Use the Bass/Treble buttons on the Remote to adjust each from -5 to +5.

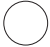
LED Behavior:

-  Red (Flash 2x) – Bass/Treble Set to -5 or +5
-  Bluetooth: Blue (Flash 2x) – Bass/Treble set to 0\*
-  RCA: Green (Flash 2x) – Bass/Treble set to 0\*
-  Optical: White (Flash 2x) – Bass/Treble set to 0\*
-  USB: Purple (Flash 2x) – Bass/Treble set to 0\*

\*NOTE: The Status LED will flash the input color when Bass/Treble is set to 0.

## Adjusting Source LED Brightness

Use the LED Brightness Button  on the Remote to cycle between 100%, 25%, and OFF brightness levels.

NOTE: When set to OFF, the LED will turn on for 5 seconds when power is turned on or new Source is selected, before turning off again.

## Frequently Asked Questions

### What is “auto-pairing” and how does it work?

Auto-pairing is a convenient connection feature included in all Fluance Bluetooth Speakers. If the connected Bluetooth-enabled device leaves the connection range of the Ai61 and returns at a later time, the device will automatically connect. If the device’s Bluetooth function is disabled and then enabled at a later time, the device will automatically connect as well.

NOTE: The Fluance Ai61 will only auto-pair to the last device that it was connected to.

### Another Bluetooth® device is connected to my Fluance Ai61 and I want to connect my device.

You can reset any Bluetooth connection by pressing the Bluetooth Pairing Reset button on the back of the Active Speaker. You can also press and hold “Play/Pause” on the Remote for 3 seconds.

### What RCA devices can be connected to the Ai61?

Any RCA device will work with the Ai61. Common devices would be TV’s, Turntables, Smartphones, or Tablets.

### How can I increase the volume when using the Ai61 with a turntable?

If turntable audio is too quiet you may need to add a preamplifier. Some turntables have built in preamps which can be turned on or off. The Fluance PA10 preamplifier is a great match for Fluance powered speakers and turntables.

### Why is the volume from each input different on the Ai61?

Ensure that any volume and EQ settings on your source devices are set to similar levels. The different signal types used by each input means they are processed differently by the Ai61. The Optical Input uses a digital signal while the RCA Input uses an analog signal. These differences can result in slight variances in the output volume of the Ai61.

### What is the range of my Bluetooth Connection?

The Fluance Ai61 operates with Power Class 2 Bluetooth devices, which have a range of approximately 33 feet (line of sight).

### What is the break-in period for Fluance speakers?

The break-in period for your Fluance Ai61 speakers is about 10 hours of playing time at normal listening volumes. After this period, the drivers will have had enough movement to perform at their peak level.

## Troubleshooting

### No Power

- Ensure the LED Brightness is not set to OFF
- Check all connections on power adapter and ensure fully inserted

### No Audio

- Check volume on Ai61 and ensure it is above 0
- Check volume on source device and ensure it is above 0
- Confirm Ai61 is set to correct source
- Ensure all cables are connected properly and fully inserted

### No Audio from Passive Speaker

- Check speaker wire connections between speakers and ensure securely connected to binding posts

### Poor Audio

- Ensure the colored wires are connected to the corresponding colored binding posts on each speaker
- Test with another audio source device to determine source of issue

### Hissing Noise

- Ensure the colored wires are connected to the corresponding colored binding posts on each speaker
- Test using different RCA or optical cables
- If using with a turntable, ensure the ground cable is connected properly



## Specifications

SPEAKER CONFIGURATION	2 Way - 2 Driver Bookshelf Speaker System with Integrated Amplifier
BLUETOOTH	Yes; BT 5.0
INPUTS	RCA L/R, Digital Toslink Optical, USB C
TWEETER	1 inch Silk Soft Dome Ferrofluid Cooled
WOOFER	6.5 inch Woven, Glass Fiber Composite Drivers with Butyl Rubber Surrounds
AMPLIFIER POWER	Class D 120 Watts Continuous Average Output (2x 60 watts)
FREQUENCY RESPONSE	32Hz - 20KHz (DSP Virtual Sound)
CROSSOVER FREQUENCY	2600Hz Phase Coherent - PCB Mounted Circuitry
TOTAL HARMONIC DISTORTION (THD)	<0.3% (THD+N 1%)
POWER	Input: 100-240V 50Hz/60Hz
SPEAKER WEIGHT	Active Speaker: 14.03 lbs (6.36 kg) Passive Speaker: 13.14 lbs (5.96 kg)
DIMENSIONS (HxWxD)	13.1 x 7.8 x 9.2 inches 33.3 x 19.8 x 23.4 cm

## Certification Information

### FCC Statement

This equipment has been tested and found to comply with the limits for a Class B digital device, pursuant to Part 15 of the FCC Rules. These limits are designed to provide reasonable protection against harmful interference in a residential installation. This equipment generates uses and can radiate radio frequency energy and, if not installed and used in accordance with the instructions, may cause harmful interference to radio communications. However, there is no guarantee that interference will not occur in a particular installation. If this equipment does cause harmful interference to radio or television reception, which can be determined by turning the equipment off and on, the user is encouraged to try to correct the interference by one or more of the following measures:

- Reorient or relocate the receiving antenna.
- Increase the separation between the equipment and receiver.
- Connect the equipment into an outlet on a circuit different from that to which the receiver is connected.
- Consult the dealer or an experienced radio/TV technician for help.

This device complies with part 15 of the FCC Rules. Operation is subject to the following two conditions: (1) This device may not cause harmful interference, and (2) this device must accept any interference received, including interference that may cause undesired operation. Changes or modifications not expressly approved by the party responsible for compliance could void the user's authority to operate the equipment. This equipment complies with FCC radiation exposure limits set forth for an uncontrolled environment. This equipment should be installed and operated with minimum distance 20cm between the radiator & your body. The device has been evaluated to meet general RF exposure requirement. The device can be used in portable exposure condition without restriction.

## IC Warning

This device complies with Industry Canada license-exempt RSS standard(s).

Operation is subject to the following two conditions:

- (1) This device may not cause interference, and
- (2) This device must accept any interference, including interference that may cause undesired operation of the device.

Le présent appareil est conforme aux CNR d'Industrie Canada applicables aux appareils radio exempts de licence. L'exploitation est autorisée aux deux conditions suivantes:

- (1) l'appareil ne doit pas produire de brouillage, et
- (2) l'utilisateur de l'appareil doit accepter tout brouillage radioélectrique subi, même si le brouillage est susceptible d'en compromettre le fonctionnement.

Changes or modifications not expressly approved by the party responsible for compliance could void the user's authority to operate the equipment. This equipment complies with IC radiation exposure limits set forth for an uncontrolled environment. This equipment should be installed and operated with minimum distance 20cm between the radiator & your body. This transmitter must not be co-located or operating in conjunction with any other antenna or transmitter.

## Warranty Information

Thank you for choosing Fluance! We guarantee your investment in our products is a solid one. High performance components combined with quality craftsmanship allow us to maintain the highest possible production standards.

All items are guaranteed against defects in materials and craftsmanship. Fluance has outstanding quality control; if something should go wrong with any of our products, we will repair it free of charge within the warranty period. If the product cannot be repaired, we will replace the product. If the product has been discontinued, we will replace the product with either the newest version of said product or current equivalent. In the event that Fluance replaces a product under warranty, the replacement would only carry the original warranty from the original date of purchase.

## Warranty Period

The Fluance products below are warrantied for parts and labor for the stated period from

date of original purchase, and are subject to the terms and conditions of the warranty. Any refurbished products that are discontinued hold a 90 day warranty from the date of original purchase. Fluance warranties are valid for the original owner and are non-transferable.

Home Audio Passive Speakers: Lifetime Warranty

Active or Powered Speakers: Two Year Warranty

HiFi Turntables: Two Year Warranty

Batteries (For Powered Speakers): One Year Warranty

## Warranty Exclusions

- Products purchased from a dealer not authorized by Fluance.
- Products with the serial number defaced, altered or missing.
- Defects resulting from disaster, accident, abuse, misuse, lightning, power surges, neglect, unauthorized modification or water damage.
- Defects or damage as a result of repairs performed by a person or party not authorized by Fluance.
- Defects or damage occurring during shipping (claims should be made with the shipping company).
- Defect or damage as a result of connecting a product to an outlet with the incorrect voltage. Voltage converters must be used where applicable.
- Consumable parts including, but not limited to, batteries, styli, and rubber belts.

## To Obtain Warranty Service

Should your product require warranty service, please contact us at [www.fluance.com/](http://www.fluance.com/) contact or call us at 1-888-617-6863 to set up a Return Authorization. Products returned without a valid Return Authorization number will be refused.

Fluance products must be returned in their original packaging. Our products are packaged specially to protect them from any damage during shipping, and without this packaging the return shipment could get damaged.

This warranty does not cover the shipping cost, insurance, or any other incidental charges. Products shipped for warranty service must be pre-paid by the customer, and Fluance will cover the cost to ship the repaired or replaced product back to the customer.

Thank you for your purchase of this Fluance® product.  
We hope you enjoy your experience.

Questions?  
Give us a chance to help, we're just a click away.



[Fluance.com/resources](https://Fluance.com/resources)



[Fluance.com/support](https://Fluance.com/support)



[Fluance.com/videos](https://Fluance.com/videos)



[Fluance.com/contact](https://Fluance.com/contact)

Don't forget to register your product with us!  
[Fluance.com/registration](https://Fluance.com/registration)