

- 1 Connect power to Receiver. Connect Receiver and TV with HDMI cable.

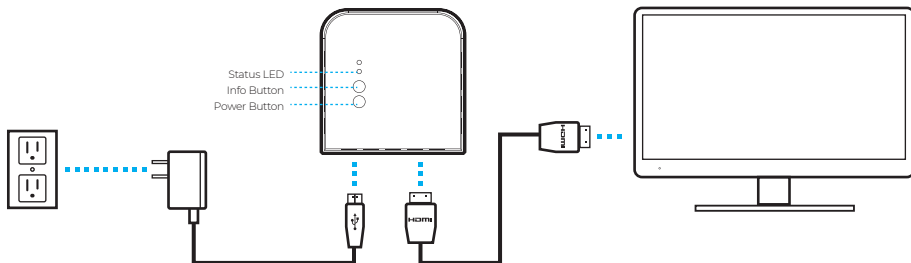

*\*Obstacles may decrease transmission distance. Interference may come from other wireless devices using 5GHz band. For maximum performance, please use the included power adapters.*

- 2 Connect Transmitter to HDMI output on computer and plug in power cord to USB port on computer.

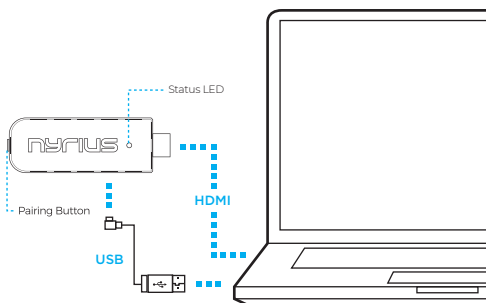

*\*Both HDMI and USB are required for connection.*

- 3 Ensure the TV is displaying the HDMI input that the NPCS600 Receiver is connected to.

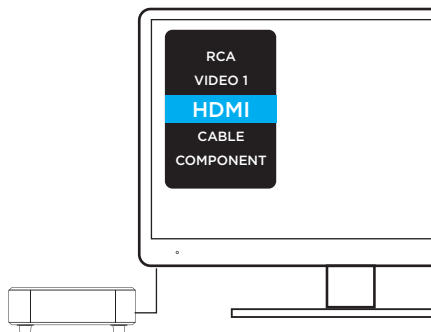

## PAIRING INSTRUCTIONS

The NPC600 Transmitter and Receiver come paired. If re-pairing is necessary use the below steps to reconnect the units.

- 1 Press and hold down the power button LED on the Receiver and plug in the power adapter. Release the power button once the power LED blinks orange.

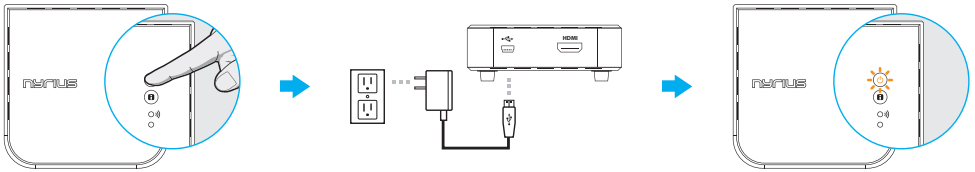

- 2 Plug the power adapter into the Transmitter. Press and hold down the pairing button.

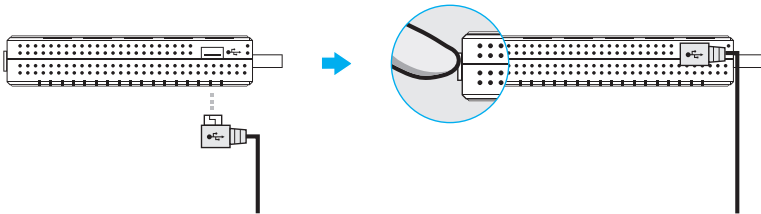

- 3 The Power LED should be flashing white. The white flashing speed will begin to slow down. Once it has slowed down, release pairing button to enter pairing mode.



**Note:** The Transmitter and Receiver should complete pairing and once LEDs change to solid white connection will be complete.

1. What does the status of the LEDs mean?

SOLID WHITE	LINKED	Transmitter/Receiver is linked.
FLASHING WHITE	SEARCHING	Transmitter/Receiver not in range. No HDMI Input connected.
SOLID ORANGE	STANDBY	Receiver in power saving mode.
SLOWLY FLASHING ORANGE	PAIRING	Receiver is in pairing mode.

2. What is the maximum transmission range?

The NPCS600 has a maximum range of 100 feet line of sight. Obstacles such as walls, doors, and wireless routers may reduce the range or cause interference, however; every application is different.

3. The NPCS600 appears warm after prolonged use.

To transmit 3D or Full HD content wirelessly, the NPCS600 must process a large amount of data. Due to this, the unit may run at warmer temperatures than other electronic devices. We have designed the housing to provide proper ventilation to the unit as well as have designed the electronic components to withstand temperatures up to 80°C. To ensure maximum performance ensure both the Transmitter and Receiver are in well ventilated areas that do not exceed 30°C.

4. What are the troubleshooting steps if no video is displayed?

The Transmitter/Receiver may require a few seconds to connect. Ensure the correct HDMI video input is selected on your TV and that your HDMI cables are connected properly. Check that your video resolution from the source device is set to 1080p, 1080i, 720p, 576p, or 480p. Please ensure the NPCS600 is not located near a wireless access point as interference may affect connectivity.

5. How can I extend my computer's desktop using the NPCS600?

You can change the display type in the computer's display settings. Normal display options are "Extend", "Duplicate" or "Show desktop only on...". If you connect the NPCS600 and only see your background image the display option is set to "Extend".

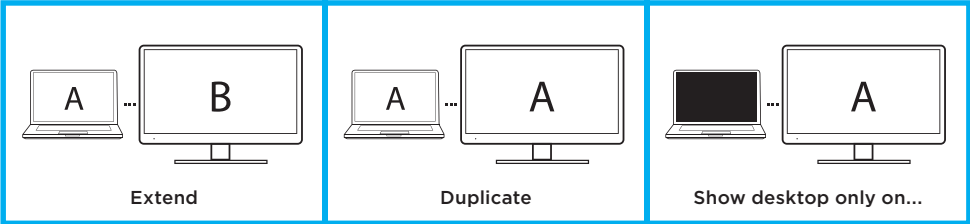

## NYRIUS® WARRANTY

### Thank you for choosing NYRIUS® Consumer Electronics Products!

NYRIUS gives the following express warranty to the original consumer purchaser or gift recipient for this NYRIUS product, when shipped in its original container and sold or distributed by NYRIUS or by an Authorized NYRIUS Dealer: NYRIUS warrants that this product is free, under normal use and maintenance, from any defects in material and workmanship. If any such defects should be found in this product within the applicable warranty period, NYRIUS shall, at its option, repair or replace the product as specified herein. Replacement parts furnished in connection with this warranty shall be warranted for a period equal to the unexpired portion of the original equipment warranty. This warranty shall not apply to:

- Any defects caused or repairs required as a result of abusive operation, negligence, accident, improper installation or inappropriate use as outlined in the owner's manual.
- Any NYRIUS product tampered with, modified, adjusted or repaired by any party other than NYRIUS or NYRIUS's Authorized Service Centres.
- Damage caused or repairs required as a result of the use with items not specified or approved by NYRIUS including but not limited to head cleaning tapes and chemical cleaning agents.
- Any replacement of accessories, glassware, consumable or peripheral items required through normal use of the product including but not limited to earphones, remote controls, AC adapters, batteries, stylus, trays, filters, cables, paper, cabinet, cabinet parts, knobs, buttons, baskets, stands and shelves.
- Any cosmetic damage to the surface or exterior that has been defaced or caused by normal wear and tear.
- Any damage caused by external or environmental conditions, including but not limited to transmission line/power line voltage or liquid spillage.
- Any product received without appropriate model, serial number and CSA /cUL /cULus /cETL /cETLus markings.
- Any products used for rental or commercial purposes.
- Any installation, setup and/or programming charges.

Should this NYRIUS product fail to operate during the warranty period, warranty service may be obtained upon delivery of the NYRIUS product together with proof of purchase and a copy of this LIMITED WARRANTY statement to an Authorized NYRIUS Service Centre. In-home warranty service may be provided at NYRIUS discretion on any NYRIUS television with the screen size of 40" or larger. This warranty constitutes the entire express warranty granted by NYRIUS and no other dealer, service centre or their agent or employee is authorized to extend, enlarge or transfer this warranty on behalf of NYRIUS. To the extent the law permits, NYRIUS disclaims any and all liability for direct or indirect damages or losses or for any incidental, special or consequential damages or loss of profits resulting from a defect in material or workmanship relating to the product, including damages for the loss of time or use of this NYRIUS product or the loss of information. The purchaser will be responsible for any removal, reinstallation, transportation and insurance costs incurred. Correction of defects, in the manner and period of time described herein, constitute complete fulfillment of all obligations and responsibilities of NYRIUS Electronics to the purchaser with respect to the product and shall constitute full satisfaction of all claims, whether based on contract, negligence, strict liability or otherwise.

### 1 YEAR PARTS & LABOUR WARRANTY PERIODS

To obtain the name and address of the nearest Authorized NYRIUS Service Centre or for more information on this warranty, visit:

[www.nyrius.com/support](http://www.nyrius.com/support)

## FCC WARNING

This device complies with Part 15 of the FCC Rules. Operation is subject to the following two conditions: (1) This device may not cause harmful interference, and (2) this device must accept any interference received, including interference that may cause undesired operation. This equipment has been tested and found to comply with the limits for a Class B digital device, pursuant to Part 15 of the FCC Rules. These limits are designed to provide reasonable protection against harmful interference in a residential installation. This equipment generates, uses and can radiate radio frequency energy and, if not installed and used in accordance with the instructions, may cause harmful interference to radio communications. However, there is no guarantee that interference will not occur in a particular installation. If this equipment does cause harmful interference to radio or television reception, which can be determined by turning the equipment off and on, the user is encouraged to try to correct the interference by one of the following measures:

- Reorient or relocate the receiving antenna.
- Increase the separation between the equipment and receiver.
- Connect the equipment into an outlet on a circuit different from that to which the receiver is connected.
- Consult the dealer or an experienced radio/TV technician for help.

## FCC CAUTION:

Any changes or modifications not expressly approved by the party responsible for compliance could void the user's authority to operate this equipment. This transmitter must not be co-located or operating in conjunction with any other antenna or transmitter. For operation within 515 ~ 525GHz / 547 ~ 5725GHz frequency range, it is restricted to indoor environment. The band from 5600-5650MHz will be disabled by the software during the manufacturing and cannot be changed by the end user. This device meets all the other requirements specified in Part 15E, Section 15.407 of the FCC Rules.

## RADIATION EXPOSURE STATEMENT (TRANSMITTER):

The product comply with the FCC portable RF exposure limit set forth for an uncontrolled environment and are safe for intended operation as described in this manual. The further RF exposure reduction can be achieved if the product can be kept as far as possible from the user body or set the device to lower output power if such function is available. The USB dongle transmitter is approved for use in typical laptop computers. To comply with FCC RF exposure requirements, it should not be used in other devices or certain laptop and tablet computer configurations where the USB connectors on the host computer are unable to provide or ensure the necessary operating configurations intended for the device and its users or bystanders to satisfy RF exposure compliance requirements. Receiver should be installed and operated with minimum distance 20cm between the radiator & your body.

## RADIATION EXPOSURE STATEMENT (RECEIVER):

This equipment complies with FCC radiation exposure limits set forth for an uncontrolled environment. This equipment should be installed and operated with minimum distance 20cm between the radiator & your body.

*Note: The country code selection is for non-US model only and is not available to all US model. Per FCC regulation, all WiFi product marketed in US must fixed to US operation channels only.*

## IC STATEMENT

This device complies with ICSED's licence-exempt RSSs. Operation is subject to the following two conditions:

(1) This device may not cause harmful interference, and (2) this device must accept any interference received, including interference that may cause undesired operation.

## CAUTION :

(i) the device for operation in the band 5150-5250 MHz is only for indoor use to reduce the potential for harmful interference to co-channel mobile satellite systems; (ii) the maximum antenna gain permitted for devices in the bands 5250-5350 MHz and 5470-5725 MHz shall be such that the equipment still complies with the e.i.r.p. limit; (iii) the maximum antenna gain permitted for devices in the band 5725-5850 MHz shall be such that the equipment still complies with the e.i.r.p. limits specified for point-to-point and non-point-to-point operation as appropriate; and (iv) Users should also be advised that high-power radars are allocated as primary users (i.e. priority users) of the bands 5250-5350 MHz and 5650-5850 MHz and that these radars could cause interference and/or damage to LE-LAN devices.

## RADIATION EXPOSURE STATEMENT:

This equipment complies with ICSED radiation exposure limits set forth for an uncontrolled environment. This equipment should be installed and operated with minimum distance 20cm between the radiator & your body.

## AVERTISSEMENT :

Le guide d'utilisation des dispositifs pour réseaux locaux doit inclure des instructions précises sur les restrictions susmentionnées, notamment: (i) les dispositifs fonctionnant dans la bande 5150-5250 MHz sont réservés uniquement pour une utilisation à l'intérieur afin de réduire les risques de brouillage préjudiciable aux systèmes de satellites mobiles utilisant les mêmes canaux; (ii) le gain maximal d'antenne permis pour les dispositifs utilisant les bandes de 5250 à 5350 MHz et de 5470 à 5725 MHz doit être conforme à la limite de la p.i.r.e.; (iii) le gain maximal d'antenne permis (pour les dispositifs utilisant la bande de 5725 à 5850 MHz) doit être conforme à la limite de la p.i.r.e. spécifiée pour l'exploitation point à point et l'exploration non point à point, selon le cas; (iv) De plus, les utilisateurs devraient aussi être avisés que les utilisateurs de radars de haute puissance sont désignés utilisateurs principaux (c.-à-d. qu'ils ont la priorité) pour les bandes 5250-5350 MHz et 5650-5850 MHz et que ces radars pourraient causer du brouillage et/ou des dommages aux dispositifs LAN-EL.

## DÉCLARATION D'EXPOSITION AUX RADIATIONS:

Cet équipement est conforme aux limites d'exposition aux rayonnements ICSED établies pour environnement non contrôlé. Cet équipement doit être installé et utilisé avec un minimum de 20 cm de distance entre la source de rayonnement et votre corps.



Thank you for your purchase.

If you require any assistance or additional  
product information, please visit:

[NYRIUS.COM/SUPPORT](https://nyrius.com/support)