

FLUANCE®

Ri91 – Reference Stereo Powered Floorstanding Speakers

Quick Start Guide v1.0

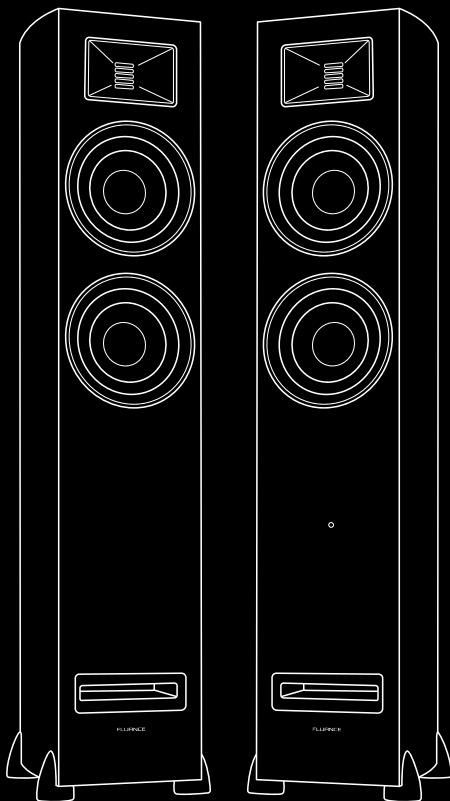

Safety Instructions

1. This unit has been designed and manufactured to ensure your personal safety. Use only for its intended use as described in this manual. Improper use can result in potential electrical shock or fire hazards. Read all safety and operating instructions carefully before installation and use. Keep these instructions for future reference. Take special note of all warnings listed in these instructions and on the unit.
2. Use only a mild cleaning solution and a clean, soft cloth. Always turn the product off before cleaning.
3. To reduce the risk of fire or electric shock, do not expose this apparatus to rain, water, or moisture. The apparatus shall not be exposed to dripping or splashing and that objects filled with liquids, such as vases, shall not be placed on apparatus. Do not place or store the apparatus where it can fall or be pulled into a tub or sink. Do not reach for unit that has fallen into water. Unplug it immediately.
4. Only use attachments/accessories/replacement parts as specified by the manufacturer.
5. Ensure that the power voltage stated on the rating label corresponds to your local electricity supply.
6. The symbol with  indicates AC voltage.
7. The symbol with  indicates DC voltage.
8. Do not defeat the safety purpose of the polarized or grounding plug. A polarized plug has two blades with one wider than the other. A grounding plug has two blades and a third grounding prong. The wide blade or the third prong is provided for your safety. If the provided plug does not fit into your outlet, consult an electrician for replacement of the obsolete outlet.
9. Protect the power cord from being walked on or pinched particularly at the plugs, convenience receptacles, and at the point where they exit from the apparatus. Never operate this unit if it has a damaged cord or plug, if it is not working properly, if it has been dropped or damaged, or dropped into water. If the unit's power supply cord or plug is damaged, do not attempt to fix it yourself. Only use a power supply of the type described in this manual, or that is marked on the unit.
10. Do not overload electrical outlet. Use only the power source as indicated.
11. The mains plug is used as disconnect device, the disconnect device shall remain readily operable.
12. Unplug the apparatus during lightning storms or when unused for long periods of time.
13. Do not install this unit in places exposed to direct sunlight or close to heat radiating appliances such as electric heaters, on top of other stereo equipment that radiates too much heat, places lacking ventilation or dusty areas, places subject to constant vibration, and/or humid or moist areas.
14. Never expose this product to extremely high or low temperatures. Using the product in a 0-35°C environment is recommended. Shipping and storing the product in a 0-35°C environment is recommended.
15. Do not install this equipment in a confined space and maintain good ventilation conditions. The ventilation should not be impeded.
16. Do not block any ventilation openings. Install in accordance with the manufacturer's instructions.
17. Use only with the cart, stand, tripod, bracket, or table specified by the manufacturer, or sold with the apparatus. When a cart or rack is used, use caution when moving the cart/apparatus combination to avoid injury from tip-over.
18. Refer all servicing to qualified service personnel. Servicing is required when the apparatus has been damaged in any way, such as power-supply cord or plug is damaged. Liquid has been spilled or objects have fallen into the apparatus, the apparatus has been exposed to rain or moisture, does not operate normally, or has been dropped.
19. If the battery compartment does not close securely, stop using the product and keep it away from children.
20. Keep new and used batteries away from children.
21. Attention should be drawn to the environmental aspects of battery disposal.
22. Battery cannot be subjected to high or low extreme temperatures, low air pressure at high altitude during use, storage or transportation.
23. The battery shall not be exposed to excessive heat such as sunshine, fire or the like.
24. Danger of explosion if battery is incorrectly replaced. Replace only with the same or equivalent type.
25. This product contains a coin/button cell battery. If the coin/button cell battery is swallowed, it can cause severe internal burns in just 2 hours and can lead to death. If you think batteries might have been swallowed or placed inside any part of the body, seek immediate medical attention.
26. The exclamation point within an equilateral triangle is intended to alert the user to the presence of important operating and maintenance (servicing) instructions in the literature accompanying the unit.
27. This lightning flash with arrowhead symbol within an equilateral triangle is intended to alert the user to the presence of non-insulated "dangerous voltage" within the product's enclosure that may be of sufficient magnitude to constitute a risk of electric shock.
28. High SPLs may damage your hearing. Please do not get close to the loudspeaker when using them at high volumes.
29. Wireless products may generate shortwave radio frequencies. The radio waves may interfere with the normal use of medical devices or other electronic devices.

Introduction

Thank you for your purchase of your Fluance product. We hope you enjoy your experience. If you have any questions please visit us at www.Fluance.com/support

Fluance believes everyone should experience audio in its truest form, recreating the performance the way the artist intended. Utilizing only superior components and expert audio engineering, our products are a testament to the performance that can be achieved when a passion for music takes center stage. The perfect complement to any audiophile's lifestyle, you'll be enjoying live performances in your home for years to come.

Break-in Period

Our speakers have a Butyl rubber ring surrounding the cone. The break-in period allows the rubber to loosen and stretch, allowing the cone a larger range of movement, resulting in better sound reproduction. We recommend 10-12 hours of play at moderate volume to achieve this.

For additional product information, please consult the manual at: Fluance.com/resources

What's Included

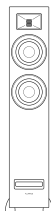

Ri91 Passive
Speaker



Ri91 Active
Speaker



Remote Control
& Batteries

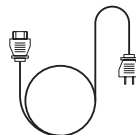

Power
Cable



Speaker
Wire

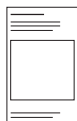

Quick Start
Guide



Lifetime
Customer Support



2 Year
Warranty

Front & Back Panel Layout

1. Control Knob

- Turn – Volume
- Press – Input Selection
- Hold – Power ON/OFF

2. Source LED

- Blue (Solid) - Bluetooth® Paired
- Blue (Flashing) - Bluetooth® Pairing Mode
- Green (Solid) - RCA 1
- Purple (Solid) - RCA 2
- White (Solid) - HDMI
- Red (Solid) - Standby Mode
- Red (Flashing) - Mute
- Red (Flash x2) - Volume Set to Max
- Red (Flash x2) - Bass/Treb Set to -6 or +6
- Source Color: Blue/Green/White/Purple (Flash x2) - Bass/Treb Set to 0

3. IR Sensor

4. Speaker Input

5. HDMI Input (ARC)

6. RCA Input 1

7. RCA Input 2

8. Subwoofer Output

9. Bluetooth Reset Pairing

10. Ground Terminal

11. Passive Speaker Output

12. AC Power Input (120-240VAC, 50/60Hz)

13. Fuse (T3.15AL 250V)

14. Power Switch

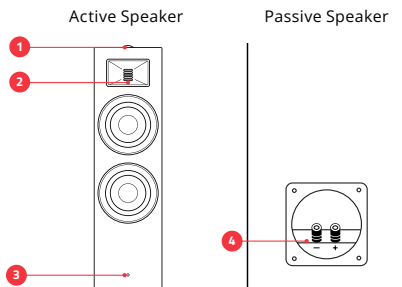

Active Speaker (Back)

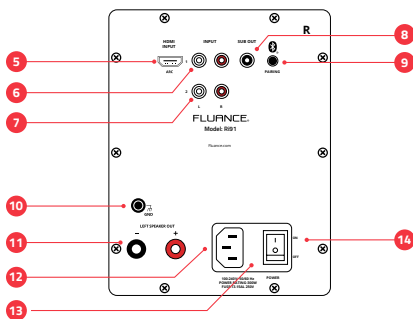

Remote Control Layout

1. Power ON/OFF

2. Volume UP/DOWN

3. Source

4. Treble UP/DOWN

5. Mute & Switch Channels

*To switch R/L channels, press + hold for 3 seconds.

6. Play/Pause & Bluetooth® Pairing Reset*

*To enable Bluetooth® Pairing Reset, press + hold for 3 seconds.

7. Forward/Back

8. LED Brightness - (100% > 25% > OFF)

9. Bass UP/DOWN

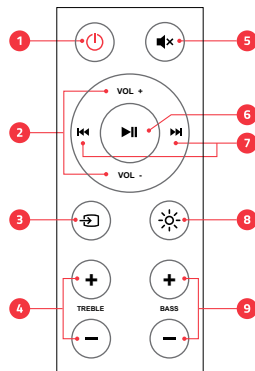

Product Setup

1. Position the speakers with the Active Speaker on the right and the Passive Speaker on the left.

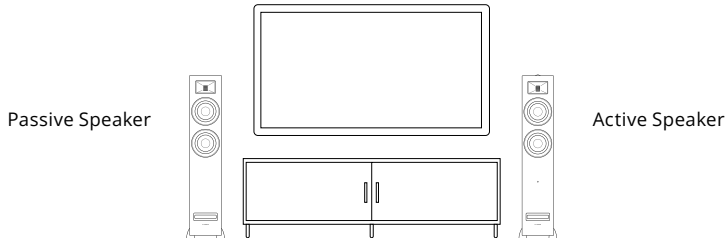

The Ri91 features the ability to swap the Right and Left channels. This may be desired if the user prefers the Control Knob on the left speaker or, if during setup, it's desired to have the Active Speaker located on the left side for connection reasons. See Switching Right and Left Channels (pg 9) for more information.

NOTE: If placing the speakers in a cabinet or on a shelf, position the front of the speakers as close as possible to the front edge of the shelf for optimum audio performance. If placing the speakers near a wall, it is recommended to keep 6-12 inches away from the wall.

2. Connect one end of the speaker wire to the binding posts on the back of the Active Speaker and connect the other end of speaker wire to the binding posts on the back of the Passive Speaker.

IMPORTANT: Ensure the same wire is connected to the same color binding post on each speaker.

NOTE: The included speaker wire is 8ft. If placing your speakers further than 8ft apart it is recommended to use standard 18 gauge speaker wire to connect the speakers over the longer distance.

3. Connect the power cable to the back of the Active Speaker and set the power switch to the ON position.

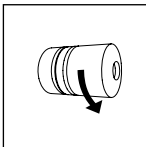

Loosen the binding post

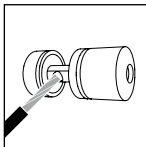

Insert speaker wire through hole

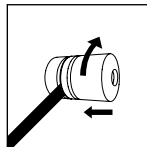

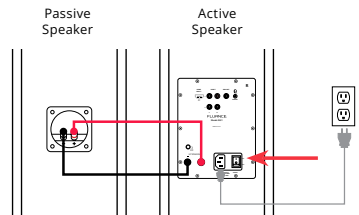

Tighten the binding post



EQ Adjustment

Use the Bass/Treble buttons on the remote to adjust each from -6 to +6.

LED Behavior:

-  Red (Flash 2x) - Bass/Treble Set to -6 or +6
-  Source Color (Flash 2x) - Bass/Treble Set to 0

Note: If using a source device, with it's own EQ settings, ensure it is set to flat(0). Some apps also include an EQ that should also be set to flat.

EQ Reset

To reset the Bass and Treble levels to 0 put the speakers into Standby mode and press and hold the Bluetooth Reset button, on the back of the speaker, until the red LED flashes. This will reset the speaker to default settings but will not reset Bluetooth settings.

RCA Input

1. Connect the RCA cable to your source device (Turntable, Smartphone, Computer...). Note: If using a turntable an internal or external preamp is required.
2. Connect the other end of the RCA cable to back of the Active Speaker.

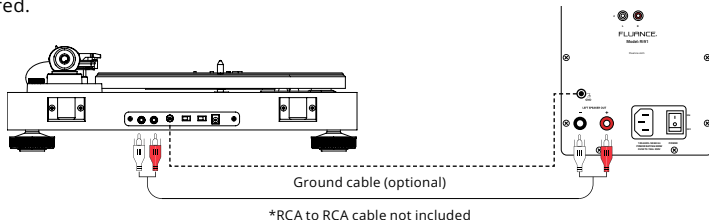

3. Press the Control Knob to select the RCA input (Green or Purple LED).
4. Adjust volume on Ri91 as well as source device.

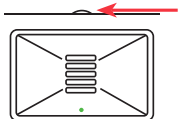

 Press the Source button on the remote control.

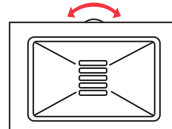

Note: If connecting a turntable it is recommended to connect a ground wire from the turntable to the Ground Terminal on the back of the Active Speaker.

HDMI Input

1. Connect the HDMI cable to a HDMI ARC output on your source device (TV, AV Receiver). The HDMI port must support ARC to work as intended.
2. Connect the other end of the HDMI cable to the back of the Active Speaker.

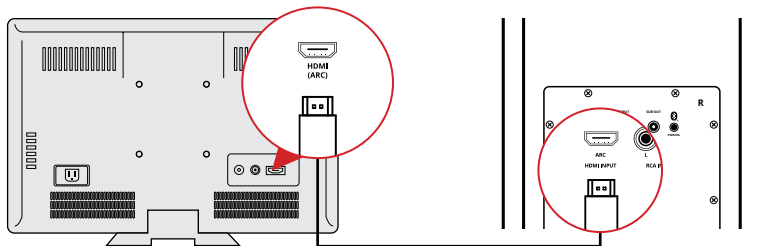

*HDMI cable not included

3. Press the Control Knob to select the HDMI Input (White LED).
4. Adjust the volume on Ri91 as well as source device.

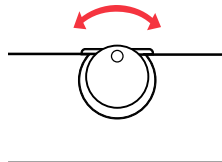
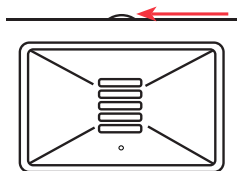

OR Press the Source button on the remote control.

HDMI ARC Audio Signal Compatibility

The Ri91 does not support Dolby Digital Audio or DTS Audio. Locate the audio output settings on your source device and ensure Dolby Digital is turned off. The correct audio output setting is commonly referred to as PCM or Stereo.

Some TVs also require that audio output be enabled. This setting may be referred to as External Speakers. Ensure this is selected as your speaker/audio output.

For instructions on a specific device, please consult the device's user manual.

Bluetooth® Pairing

1. Press the Control Knob to select the Bluetooth® input (Blue LED).

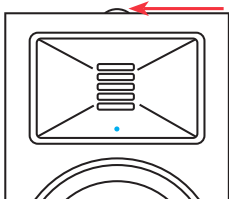

OR Press the Source button on the remote control.

3. Use the Remote to Play/Pause and go Forward/Backward on your source device.

Note: Adjust Volume on the source device as well as the Ri91.



Important: Ensure any apps and devices have the EQ disabled (flat) and Volume Normalization disabled for best performance.

2. Pair to “Fluance Ri91” on your source device.

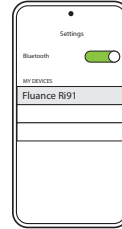

Note: Unit will attempt to auto-pair to the last paired device.

4. If your device cannot find “Fluance Ri91”, you can reset Bluetooth® pairing.

- Press and hold **▶||** on the Remote for 3 seconds to reset Bluetooth® pairing.

OR Press the Bluetooth® Pairing Reset button on the back of the unit.

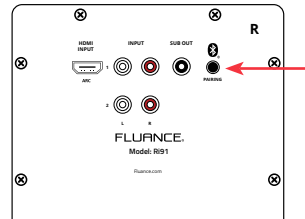

Note: How you access your device's Bluetooth® settings may vary from one manufacturer to another. Maximum line of sight for Bluetooth® range is 33ft. Obstacles may decrease transmission distance. Keep away from Wi-Fi routers or other sources of wireless interference.

Subwoofer Output

1. Connect the Subwoofer cable to your powered subwoofer.
2. Connect the other end of the Subwoofer cable to the back of the Active Speaker.
3. Adjust the volume on the Subwoofer for the best listening experience.

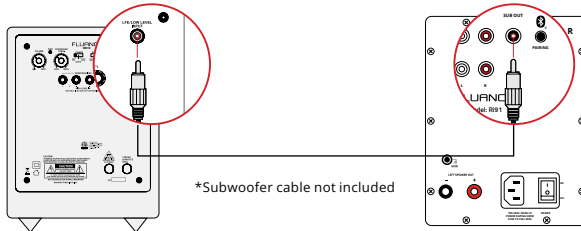

Fluance offers matching subwoofers for the ultimate audio experience. For more information visit: www.Fluance.com/subwoofer.

Switching Right and Left Channels

By default, the right channel is set to the Active Speaker. Some users may wish to switch the Right and Left channels between the Active and Passive Speakers. The below steps can be followed to change between audio channel configuration options.

1. Press and hold the Mute button on the remote control for 3 secs.
2. The LED will flash depending on the option selected.

Option 1 (default)

Active Speaker = Right Channel

Passive Speaker = Left Channel

LED Indicator: Flash source color 4x

Option 2

Active Speaker = Left Channel

Passive Speaker = Right Channel

LED Indicator: Flash source color 2x

Note: This setting will be reset to the default Option 1 if the EQ Reset function is used.

Frequently Asked Questions

Why is there no sound from the Ri91 when connected to the HDMI Input?

Many digital audio sources feature Dolby Audio which is not supported by the Ri91. Ensure your device's audio output is set to Stereo or PCM. See page 7 for more information.

What if audio is only coming from the Active Speaker?

The most common cause of no audio from one speaker is a poor connection. Ensure the metal portion of the speaker wire is in direct contact with the binding posts on both ends.

What do I do if my remote control is not working?

Replace the battery in the remote with a new one. Ensure you are pointing the remote at the IR sensor on the Active Speaker and that nothing is blocking the sensor. If the issue persists, confirm there are no wireless devices located in close proximity to the remote and speakers.

Another Bluetooth® device is connected to my Fluance Ri91 and I want to connect my device.

You can reset any Bluetooth connection by pressing the Bluetooth Pairing Reset button on the back of the Active Speaker. You can also press and hold "Play/Pause" on the Remote for 3 seconds.

How can I increase the volume when using the Ri91 with a turntable?

If turntable audio is too quiet you may need to add a preamplifier. Some turntables have built-in preamps which can be turned on or off. The Fluance PA10 preamplifier is a great match for Fluance powered speakers and turntables.

Why is the volume from each input/song different on the Ri91?

Ensure that any volume normalization and EQ settings on your source devices are disabled. The different signal types used by each input means they are processed differently by the Ri91. The HDMI Input uses a digital signal while the RCA Input uses an analog signal. These differences can result in slight variances in the output volume of the Ri91.

Why are my speakers quiet when I stream music?

Confirm the volume on your source device is turned up. If the issue persists your device or app may have volume limiting settings that are affecting the overall volume of your music. It is recommended to disable any Volume/Audio Normalization settings on your device and app. These settings can adjust the volume level of all audio and negatively affect the performance of the speakers. Ensure these settings are disabled and that any EQ settings are set to flat.

How do I clean the speakers?

To clean the speakers, use a dry lint-free microfiber cloth.



Need Help?

Scan this QR code for easy setup instructions, videos, and frequently asked questions.

Certification Information

FCC Statement

This equipment has been tested and found to comply with the limits for a Class B digital device, pursuant to Part 15 of the FCC Rules. These limits are designed to provide reasonable protection against harmful interference in a residential installation. This equipment generates uses and can radiate radio frequency energy and, if not installed and used in accordance with the instructions, may cause harmful interference to radio communications. However, there is no guarantee that interference will not occur in a particular installation. If this equipment does cause harmful interference to radio or television reception, which can be determined by turning the equipment off and on, the user is encouraged to try to correct the interference by one or more of the following measures:

- Reorient or relocate the receiving antenna.
- Increase the separation between the equipment and receiver.
- Connect the equipment into an outlet on a circuit different from that to which the receiver is connected.
- Consult the dealer or an experienced radio/TV technician for help.

This device complies with part 15 of the FCC Rules. Operation is subject to the following two conditions: (1) This device may not cause harmful interference, and (2) this device must accept any interference received, including interference that may cause undesired operation.

Changes or modifications not expressly approved by the party responsible for compliance could void the user's authority to operate the equipment. This equipment complies with FCC radiation exposure limits set forth for an uncontrolled environment. This equipment should be installed and operated with minimum distance 20cm between the radiator & your body.

The device has been evaluated to meet general RF exposure requirement. The device can be used in portable exposure condition without restriction.

IC Warning

This class [B] apparatus complies with Canadian ICES-003.

This device complies with Industry Canada license-exempt RSS standard(s).

Operation is subject to the following two conditions:

(1) This device may not cause interference, and (2) This device must accept any interference, including interference that may cause undesired operation of the device.

Cet appareil numérique de la classe B est conforme à la norme NMB-003 du Canada.

Le présent appareil est conforme aux CNR d'Industrie Canada applicables aux appareils radio exempts de licence. L'exploitation est autorisée aux deux conditions suivantes:

(1) l'appareil ne doit pas produire de brouillage, et

(2) l'utilisateur de l'appareil doit accepter tout brouillage radioélectrique subi, même si le brouillage est susceptible d'en compromettre le fonctionnement.

Changes or modifications not expressly approved by the party responsible for compliance could void the user's authority to operate the equipment. This equipment complies with IC radiation exposure limits set forth for an uncontrolled environment. This equipment should be installed and operated with minimum distance 20cm between the radiator & your body. This transmitter must not be co-located or operating in conjunction with any other antenna or transmitter.

Warranty Information

Thank you for choosing Fluance! We guarantee your investment in our products is a solid one. High performance components combined with quality craftsmanship allow us to maintain the highest possible production standards. All items are guaranteed against defects in materials and craftsmanship. Fluance has outstanding quality control; if something should go wrong with any of our products, we will repair it free of charge within the warranty period. If the product cannot be repaired, we will replace the product. If the product has been discontinued, we will replace the product with either the newest version of said product or current equivalent. In the event that Fluance replaces a product under warranty, the replacement would only carry the original warranty from the original date of purchase.

Warranty Period

The Fluance products below are warrantied for parts and labor for the stated period from date of original purchase, and are subject to the terms and conditions of the warranty. Any refurbished products that are discontinued hold a 90 day warranty from the date of original purchase. Fluance warranties are valid for the original owner and are non-transferable.

Home Audio Passive Speakers: Lifetime Warranty
Active/Powered Speakers: Two Year Warranty
HiFi Turntables: Two Year Warranty
Batteries (For Powered Speakers): One Year Warranty

Warranty Exclusions

- Products purchased from a dealer not authorized by Fluance.
- Products with the serial number defaced, altered, or missing.
- Defects resulting from disaster, accident, abuse, misuse, lightning, power surges, neglect, unauthorized modification or water damage.
- Defect or damage as a result of repairs performed by a person or party not authorized by Fluance.
- Defects of damage occurring during shipping (claims should be made with the shipping company).
- Defect or damage as a result of connecting a product to an outlet with the incorrect voltage. Voltage converters must be used where applicable.
- Consumable parts including, but not limited to, batteries, styli, and rubber belts.

To Obtain Warranty Service

Should your product require warranty service, please contact us at www.fluance.com/contact or call us at 1-888-617-6863 to set up a Return Authorization. Products returned without a valid Return Authorization number will be refused.

Fluance products must be returned in their original packaging. Our products are packaged specially to protect them from any damage during shipping, and without this packaging the return shipment could get damaged.

This warranty does not cover the shipping cost, insurance, or any other incidental charges. Products shipped for warranty service must be pre-paid by the customer, and Fluance will cover the cost to ship the repaired or replaced product back to the customer.

Thank you for your purchase of this Fluance® product.
We hope you enjoy your experience.

Questions?
Give us a chance to help, we're just a click away.



Fluance.com/resources



Fluance.com/support



Fluance.com/videos



Fluance.com/contact

Don't forget to register your product with us!
Fluance.com/registration