

- 1 Connect power to Receiver. Connect Receiver and TV with HDMI cable.

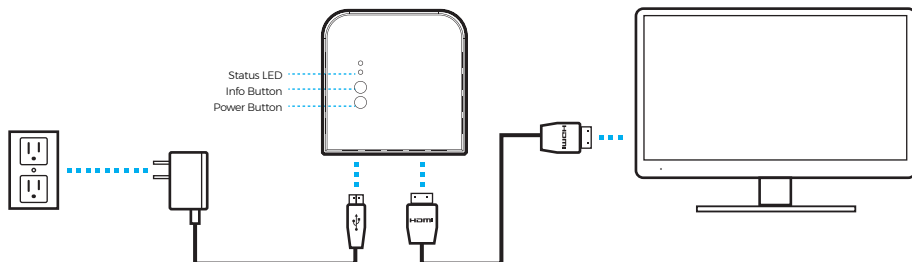

* Obstacles may decrease transmission distance. Interference may come from other wireless devices using 5GHz band. For maximum performance, please use the included power adapters.

- 2 Transmitter setup

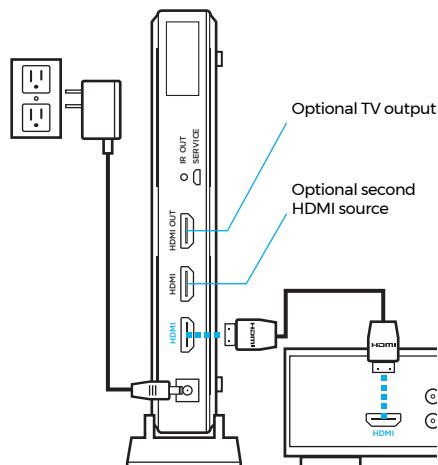

- 3 IR Extender setup

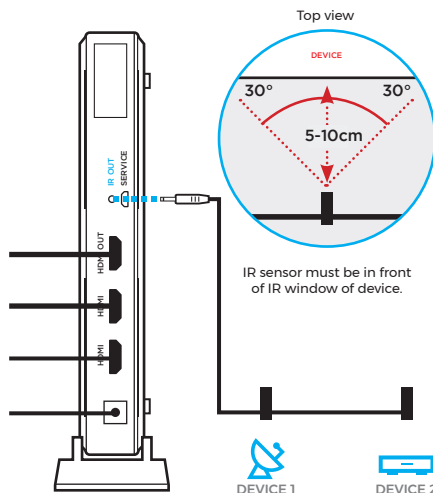

1 Remote control buttons & functions

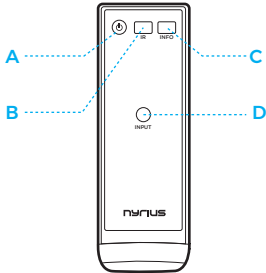

A	Power Turns transmitter / receiver ON / OFF
B	IR Press if remote extender is unresponsive
C	Info Displays current system settings
D	Input Cycles through audio / video sources

2 Power On

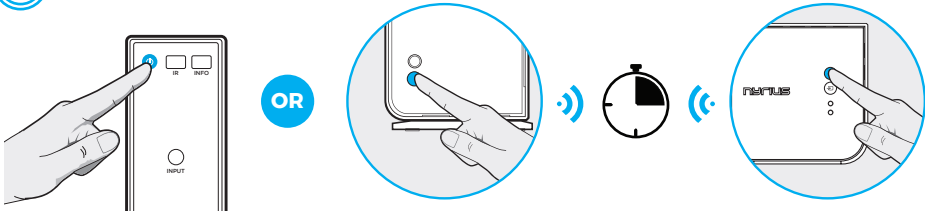

Allow 8-10 seconds to connect

3 Setup

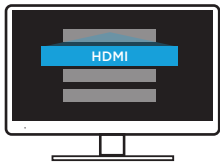

Select HDMI from your TV's source/input menu

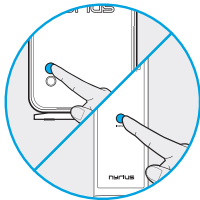

Select HDMI input 1 or 2 by using the input button on your remote or transmitter/receiver



Ensure the Aries Unit is on the correct input source, on both your TV, and Aries unit

* Obstacles may decrease transmission distance. Interference may come from other wireless devices using 5GHz band.

IR EXTENDER SETUP

What is an IR Extender cable?

The ARIESTM Home and Home+ come with an IR Extender that allows you to control your source device with its remote from the TV's location. The remote's IR signal is transmitted by the Receiver to the Transmitter and then through the IR Extender to the source device.

Need help finding your IR sensor?

Cut a piece of cardboard to the same size as the front panel of your source device and place a 1 inch hole in the middle of the cardboard. Power ON your source device and play a movie or other video content. Place the cardboard hole over the left side of the source device and using the source device's remote control directly over the cardboard hole, press the pause button repetitively while gradually moving the cardboard hole from left to right making sure to keep the remote control's beam directly over the cardboard hole. Once the source device recognizes the pause button being pressed, you have located the position of the remote control IR sensor on the source device and that is where you will place the IR Extender's sensor.

- 1 Plug the IR Extender cable in to the IR "Out" jack of the Transmitter. Position the IR Extender head in front but not on the IR sensor of your HD audio/video source device(s).

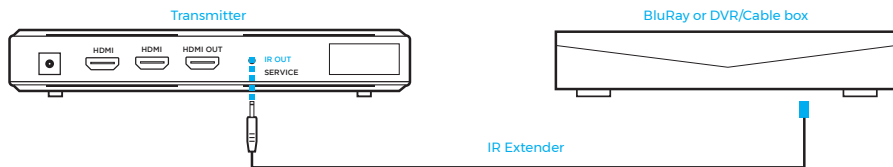

*Connect up to 2 devices with NAVS502 only.

- 2 Ensure the front of the NAVS502 Receiver is visible to receive the commands from the remote.

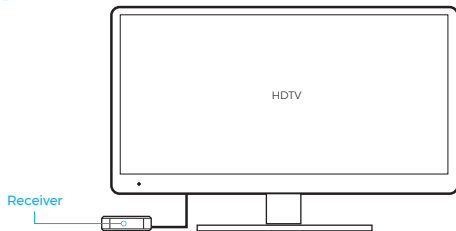

Please Note:

Obstacles will decrease the distance of the IR Extender. Transmitter and source devices connected to the Transmitter must all be in line of sight for IR control.

1. What does the status of the LEDs mean?

SOLID WHITE	LINKED	Transmitter/Receiver is linked.
FLASHING WHITE	SEARCHING	Transmitter/Receiver not in range. No HDMI Input connected.
Receiver: SOLID ORANGE	STANDBY	Transmitter/Receiver in power saving mode.
Transmitter: SOLID RED	STANDBY	Transmitter/Receiver in power saving mode.

2. What is the maximum transmission range?

The maximum range is 100 feet line of sight. If transmitting through walls or obstacles the range will be reduced.

3. What steps can I take if the IR Extender is not working?

For proper IR Extender configuration please refer to the included Quick Start Guide. To locate the IR sensor on your device, please contact the manufacturer of your HDMI enabled product. (E.G. Cable box, Blue Ray player, DVD Player). If the issue persists the IR Frequency can be adjusted by pressing IR on the remote control. The available frequencies are 38 KHz, 47 KHz, and 58 KHz.

4. How do I transmit Standard Definition content?

The Aries Home/Home+ cannot transmit 480i resolution. To ensure your standard definition content can be transmitted successfully, ensure your HDMI source and television settings are set to 480p resolution.

5. The Aries Home/Home+ appears warm after prolonged use.

To transmit 3D or Full HD content wirelessly, the Aries Home/Home+ must process a large amount of data. Due to this, the unit may run at warmer temperatures than other electronic devices. We have designed the housing to provide proper ventilation to the unit as well as have designed the electronic components to withstand temperatures up to 80°C. To ensure maximum performance ensure both the Transmitter and Receiver are placed in well ventilated areas that do not exceed 30°C.

6. What are the troubleshooting steps if no video is displayed and the Receiver shows “Searching available channels”?

The Transmitter/Receiver may require a few seconds to connect. Ensure the correct HDMI video input is selected on your TV and that your HDMI cables are connected properly. Check that your video resolution from the source device is set to 1080p, 1080i, 720p, 576p, or 480p. Please ensure the Aries Home/Home+ is not located near a wireless access point as interference may affect connectivity.

NYRIUS® WARRANTY

Thank you for choosing NYRIUS® Consumer Electronics Products!

NYRIUS gives the following express warranty to the original consumer purchaser or gift recipient for this NYRIUS product, when shipped in its original container and sold or distributed by NYRIUS or by an Authorized NYRIUS Dealer: NYRIUS warrants that this product is free, under normal use and maintenance, from any defects in material and workmanship. If any such defects should be found in this product within the applicable warranty period, NYRIUS shall, at its option, repair or replace the product as specified herein. Replacement parts furnished in connection with this warranty shall be warranted for a period equal to the unexpired portion of the original equipment warranty. This warranty shall not apply to:

- Any defects caused or repairs required as a result of abusive operation, negligence, accident, improper installation or inappropriate use as outlined in the owner's manual.
- Any NYRIUS product tampered with, modified, adjusted or repaired by any party other than NYRIUS or NYRIUS's Authorized Service Centres.
- Damage caused or repairs required as a result of the use with items not specified or approved by NYRIUS including but not limited to head cleaning tapes and chemical cleaning agents.
- Any replacement of accessories, glassware, consumable or peripheral items required through normal use of the product including but not limited to earphones, remote controls, AC adapters, batteries, stylus, trays, filters, cables, paper, cabinet, cabinet parts, knobs, buttons, baskets, stands and shelves.
- Any cosmetic damage to the surface or exterior that has been defaced or caused by normal wear and tear.
- Any damage caused by external or environmental conditions, including but not limited to transmission line/power line voltage or liquid spillage.
- Any product received without appropriate model, serial number and CSA /cUL /cULus /cETL /cETLus markings.
- Any products used for rental or commercial purposes.
- Any installation, setup and/or programming charges.

Should this NYRIUS product fail to operate during the warranty period, warranty service may be obtained upon delivery of the NYRIUS product together with proof of purchase and a copy of this LIMITED WARRANTY statement to an Authorized NYRIUS Service Centre. In-home warranty service may be provided at NYRIUS discretion on any NYRIUS television with the screen size of 40" or larger. This warranty constitutes the entire express warranty granted by NYRIUS and no other dealer, service centre or their agent or employee is authorized to extend, enlarge or transfer this warranty on behalf of NYRIUS. To the extent the law permits, NYRIUS disclaims any and all liability for direct or indirect damages or losses or for any incidental, special or consequential damages or loss of profits resulting from a defect in material or workmanship relating to the product, including damages for the loss of time or use of this NYRIUS product or the loss of information. The purchaser will be responsible for any removal, reinstallation, transportation and insurance costs incurred. Correction of defects, in the manner and period of time described herein, constitute complete fulfillment of all obligations and responsibilities of NYRIUS Electronics to the purchaser with respect to the product and shall constitute full satisfaction of all claims, whether based on contract, negligence, strict liability or otherwise.

1 YEAR PARTS & LABOUR WARRANTY PERIODS

To obtain the name and address of the nearest Authorized NYRIUS Service Centre or for more information on this warranty, visit:

www.nyrius.com/support

FCC WARNING

This device complies with Part 15 of the FCC Rules. Operation is subject to the following two conditions: (1) This device may not cause harmful interference, and (2) this device must accept any interference received, including interference that may cause undesired operation. This equipment has been tested and found to comply with the limits for a Class B digital device, pursuant to Part 15 of the FCC Rules. These limits are designed to provide reasonable protection against harmful interference in a residential installation. This equipment generates, uses and can radiate radio frequency energy and, if not installed and used in accordance with the instructions, may cause harmful interference to radio communications. However, there is no guarantee that interference will not occur in a particular installation. If this equipment does cause harmful interference to radio or television reception, which can be determined by turning the equipment off and on, the user is encouraged to try to correct the interference by one of the following measures:

- Reorient or relocate the receiving antenna.
- Increase the separation between the equipment and receiver.
- Connect the equipment into an outlet on a circuit different from that to which the receiver is connected.
- Consult the dealer or an experienced radio/TV technician for help.

FCC CAUTION:

Any changes or modifications not expressly approved by the party responsible for compliance could void the user's authority to operate this equipment. This transmitter must not be co-located or operating in conjunction with any other antenna or transmitter. For operation within 515 ~ 525GHz / 547 ~ 5725GHz frequency range, it is restricted to indoor environment. The band from 5600-5650MHz will be disabled by the software during the manufacturing and cannot be changed by the end user. This device meets all the other requirements specified in Part 15E, Section 15.407 of the FCC Rules.

RADIATION EXPOSURE STATEMENT (TRANSMITTER):

The product comply with the FCC portable RF exposure limit set forth for an uncontrolled environment and are safe for intended operation as described in this manual. The further RF exposure reduction can be achieved if the product can be kept as far as possible from the user body or set the device to lower output power if such function is available. The USB dongle transmitter is approved for use in typical laptop computers. To comply with FCC RF exposure requirements, it should not be used in other devices or certain laptop and tablet computer configurations where the USB connectors on the host computer are unable to provide or ensure the necessary operating configurations intended for the device and its users or bystanders to satisfy RF exposure compliance requirements. Receiver should be installed and operated with minimum distance 20cm between the radiator & your body.

RADIATION EXPOSURE STATEMENT (RECEIVER):

This equipment complies with FCC radiation exposure limits set forth for an uncontrolled environment. This equipment should be installed and operated with minimum distance 20cm between the radiator & your body.

Note: The country code selection is for non-US model only and is not available to all US model. Per FCC regulation, all WiFi product marketed in US must fixed to US operation channels only.

IC STATEMENT

This device complies with ISCED's licence-exempt RSSs. Operation is subject to the following two conditions: (1) This device may not cause harmful interference, and (2) this device must accept any interference received, including interference that may cause undesired operation.

CAUTION :

(i) the device for operation in the band 5150-5250 MHz is only for indoor use to reduce the potential for harmful interference to co-channel mobile satellite systems; (ii) the maximum antenna gain permitted for devices in the bands 5250-5350 MHz and 5470-5725 MHz shall be such that the equipment still complies with the e.i.r.p. limit; (iii) the maximum antenna gain permitted for devices in the band 5725-5850 MHz shall be such that the equipment still complies with the e.i.r.p. limits specified for point-to-point and non-point-to-point operation as appropriate; and (iv) Users should also be advised that high-power radars are allocated as primary users (i.e. priority users) of the bands 5250-5350 MHz and 5650-5850 MHz and that these radars could cause interference and/or damage to LE-LAN devices.

RADIATION EXPOSURE STATEMENT:

This equipment complies with ISCED radiation exposure limits set forth for an uncontrolled environment. This equipment should be installed and operated with minimum distance 20cm between the radiator & your body.

AVERTISSEMENT :

Le guide d'utilisation des dispositifs pour réseaux locaux doit inclure des instructions précises sur les restrictions susmentionnées, notamment: (i) les dispositifs fonctionnant dans la bande 5150-5250 MHz sont réservés uniquement pour une utilisation à l'intérieur afin de réduire les risques de brouillage préjudiciable aux systèmes de satellites mobiles utilisant les mêmes canaux; (ii) le gain maximal d'antenne permis pour les dispositifs utilisant les bandes de 5250 à 5350 MHz et de 5470 à 5725 MHz doit être conforme à la limite de la p.i.r.e.; (iii) le gain maximal d'antenne permis (pour les dispositifs utilisant la bande de 5725 à 5850 MHz) doit être conforme à la limite de la p.i.r.e. spécifiée pour l'exploitation point à point et l'exploration non point à point, selon le cas; (iv) De plus, les utilisateurs devraient aussi être avisés que les utilisateurs de radars de haute puissance sont désignés utilisateurs principaux (c.-à-d., qu'ils ont la priorité) pour les bandes 5250-5350 MHz et 5650-5850 MHz et que ces radars pourraient causer du brouillage et/ou des dommages aux dispositifs LAN-EL.

DÉCLARATION D'EXPOSITION AUX RADIATIONS:

Cet équipement est conforme aux limites d'exposition aux rayonnements ISCED établies pour environnement non contrôlé. Cet équipement doit être installé et utilisé avec un minimum de 20 cm de distance entre la source de rayonnement et votre corps.



Thank you for your purchase.

If you require any assistance or additional
product information, please visit:

[NYRIUS.COM/SUPPORT](https://nyrius.com/support)