

nyrius®

SONGO™ PORTABLE (BR41)

INSTRUCTION MANUAL

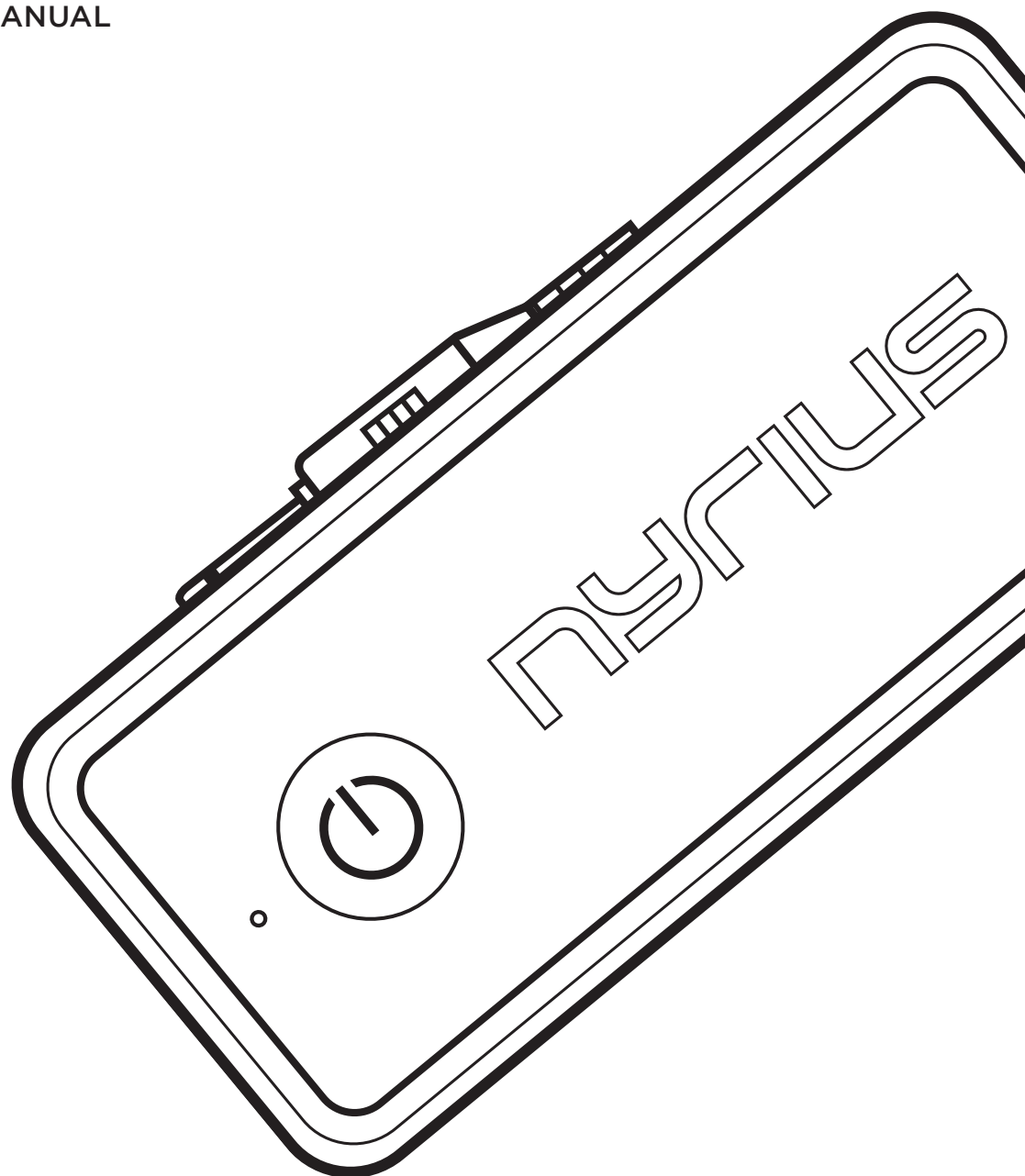

WIRELESS BLUETOOTH®
MUSIC RECEIVER

CONTENT

ABOUT SONGO® PORTABLE (BR41)3

SYSTEM REQUIREMENTS3

OVERVIEW3

WHAT'S INCLUDED.....3

STORING THE CABLE4

TURNING ON/OFF THE RECEIVER.....5

PAIRING WITH BLUETOOTH DEVICE5

PAIRING WITH BLUETOOTH TRANSMITTER.....6

LED INDICATOR.....8

TROUBLESHOOTING9

SPECIFICATIONS10

FCC STATEMENT11

ICC STATEMENT11

SAFETY INFORMATION12

WARRANTY.....13

ABOUT SONGO® PORTABLE (BR41)

The BR41 is a stereo Bluetooth® receiver. You can use any common speaker system with 3.5mm audio jack for playing any Bluetooth-enabled device's music after plugging in the Songo™ Portable (BR41).

SYSTEM REQUIREMENTS

Audio device with 3.5mm AUX input jack, such as speakers, car audio, etc.

OVERVIEW

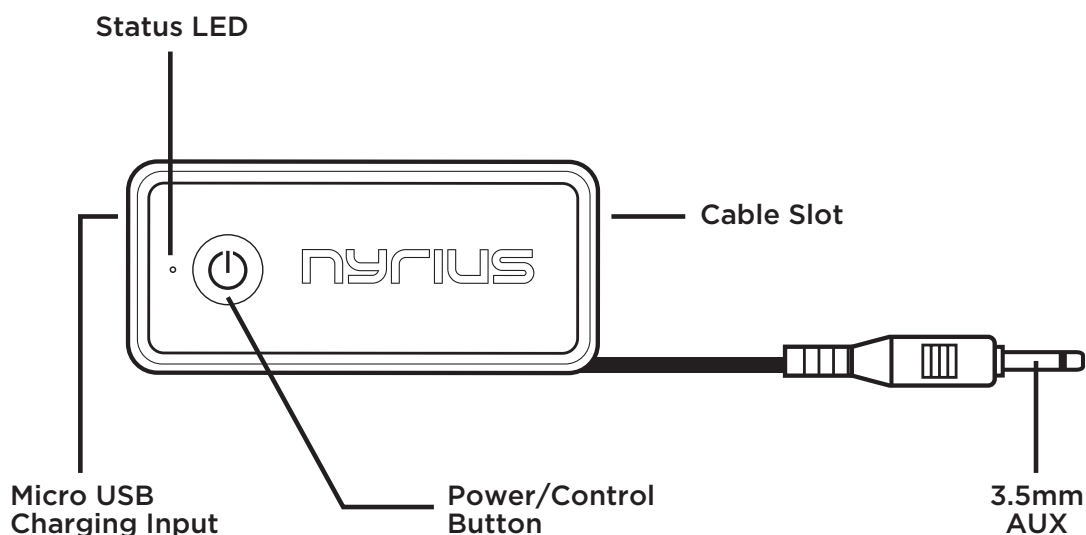

WHAT'S INCLUDED

Bluetooth Music Receiver with built-in Auxiliary Cable and Lithium polymer battery

USB Charging Cable

Quick Start Guide

AUX Coupler

Velcro Strip

1 Year Manufacturer's Direct Warranty

Lifetime Customer Support

CHARGING THE RECEIVER

BR41 comes with a built-in rechargeable battery, prior to using it, it is recommended to charge the battery fully for the first time.

When the battery is low, the BR41 will emit a warning every minute.
Please recharge to full capacity. Average charging time is 2 hours.

1. Plug the USB charging cable into the charging jack of PC or charger.
2. Plug the end of the USB charging cable into the USB input of BR41.

RED LED on = Charging

RED LED off = Finished charging

STORING THE CABLE

1. Please wrap the AUX cable into cable slot when not in use.

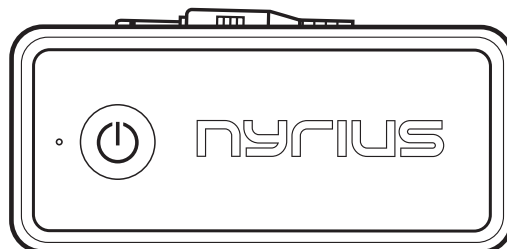
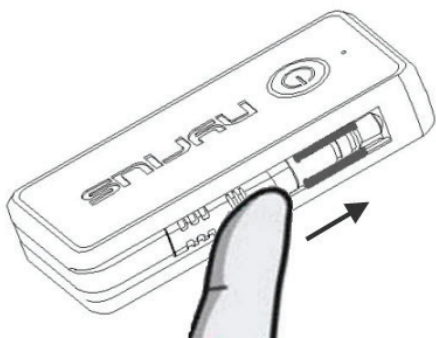

2. Unwrap the AUX cable from the cable slot as shown before use.

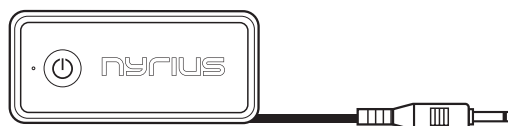
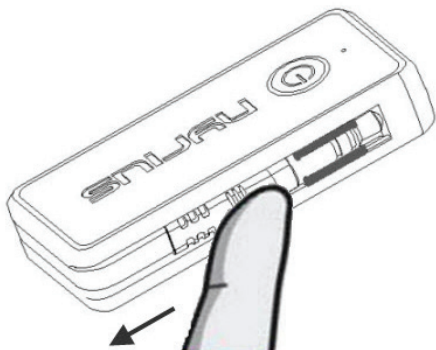

TURNING ON/OFF THE RECEIVER

FUNCTION	OPERATION	LED INDICATOR	VOICE INDICATOR
Turning ON	Press and hold POWER button for 3-4 seconds	White LED is on for 1 second	Power on
Turning OFF	Press and hold POWER button for 3-4 seconds	Red LED is on for 1 second	Power off

PAIRING WITH BLUETOOTH DEVICE

1. How to enter pairing mode

FUNCTION	OPERATION	LED INDICATOR	VOICE INDICATOR
Entering pairing mode	Ensure the receiver is turned off, otherwise turn it off first and then press and hold POWER button for 6-7 seconds .	White LED is on for 1 second and off for 1 second.	Pairing

Note: The pairing mode will last 2 minutes, the receiver will switch to standby mode automatically if no devices can be connected over 2 minutes.

2. Pairing with Bluetooth device

Prior to using the receiver for the first time, the BR41 will need to be paired with a Bluetooth enabled device. The general pairing procedures are as follows:

- Place the BR41 and Bluetooth enabled device so that they are located no more than one meter line of sight.
- Make the receiver enter pairing mode (please refer to *1. How to enter pairing mode*)
- Activate your Bluetooth enabled device's Bluetooth function, set your device to search for Bluetooth devices within range, and select "Nyrius BR41" from the list of devices shown. After successfully connecting, the white LED will remain solid.

PAIRING WITH BLUETOOTH TRANSMITTER

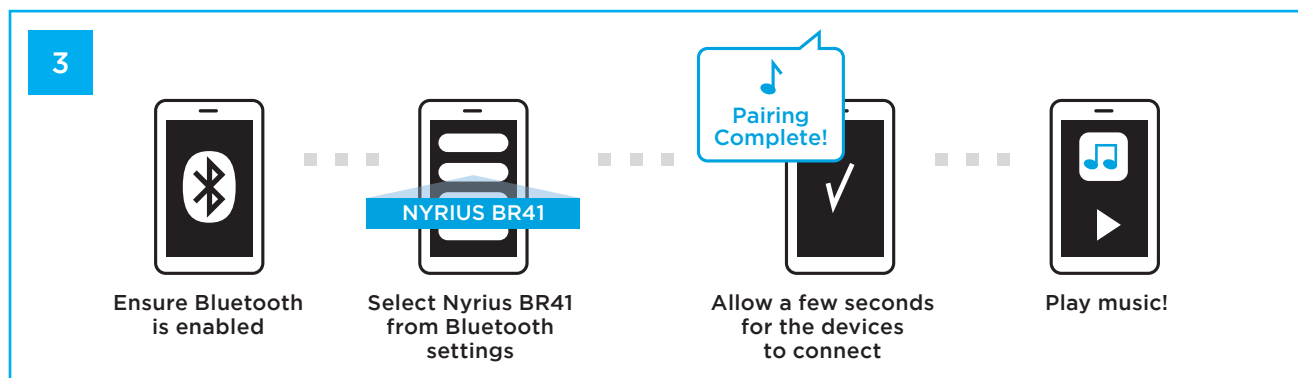
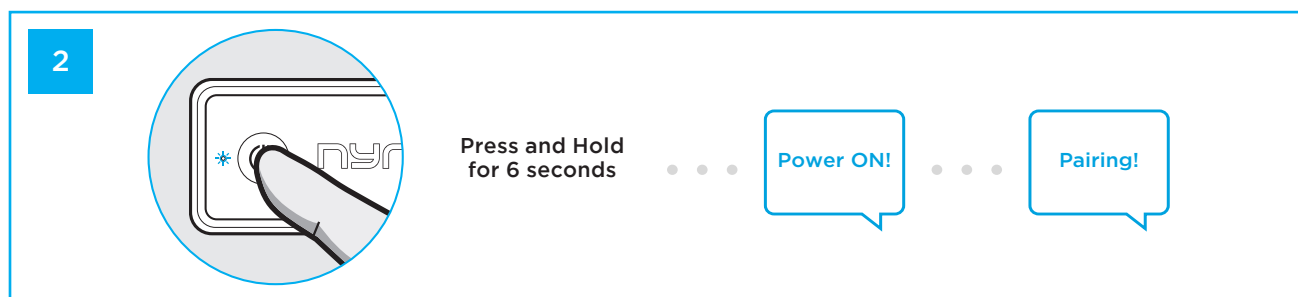
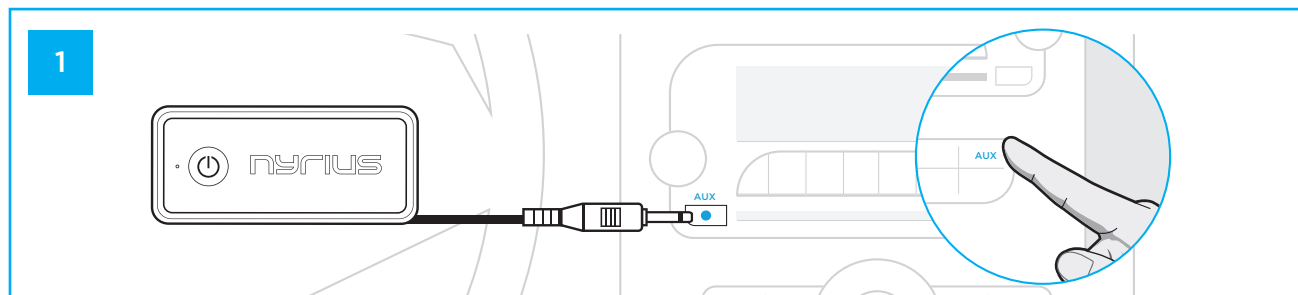

Note:

If the BR41 is turned on and doesn't connect to any devices, TAP the POWER button once, the receiver will connect to the last connected device.

When the receiver and the Bluetooth device are out of range the BR41 will disconnect. They can connect to each other automatically once in range through Auto-pairing.

PLAYING MUSIC

Connect the BR41 to your Bluetooth enabled device and plug the 3.5mm AUX cable of the BR41 into your speaker system to listen to music wirelessly.

FUNCTION	STATUS OF BR41	OPERATION
Pause	Playing music	Tap POWER button once
Play	Pausing	Tap POWER button once
Skip Track	Playing Music	Tap POWER button twice

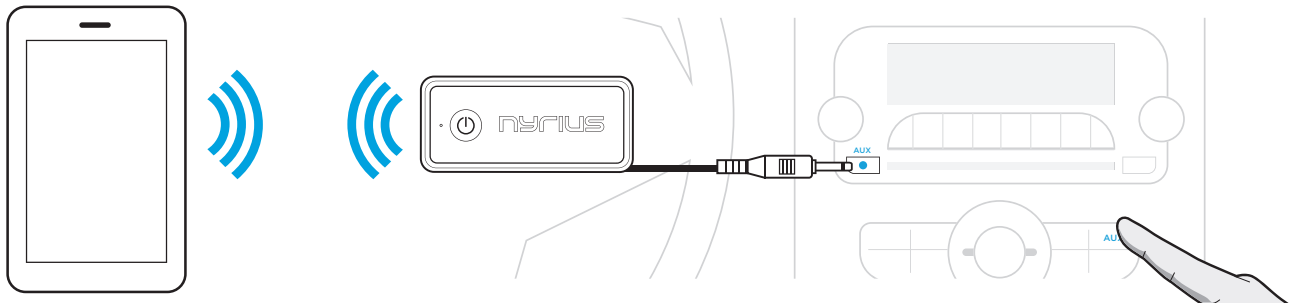

Note: The music will automatically pause when you dial a phone number or there is an incoming call.

LED INDICATOR

LED INDICATOR	STATUS OF BR41
White LED is on for 1 second and off for 1 second	Pairing mode
White LED flashes once every 2 seconds	Not connected with device
White LED flashes twice quickly every 4 seconds	Connected with device
Red LED flashes instead of white LED	Low battery

TROUBLESHOOTING

PROBLEM	DEVICE	BLUETOOTH RECEIVER
BR41 can't be turned on		Charge the battery fully for the first time
BR41 can't be turned on		Please charge the BR41 for about 2 seconds
No music from stereo	<p>Confirm that Bluetooth function is ON</p> <p>Confirm you are connected via Bluetooth with the Bluetooth Receiver</p> <p>Confirm you are playing music from your device</p> <p>Confirm you are within range of the Bluetooth Receiver</p>	<p>Confirm Bluetooth Receiver is powered</p> <p>Confirm audio cable is correctly and firmly connected to the Bluetooth Receiver</p> <p>Confirm the stereo volume is set to a comfortable listening level</p> <p>Confirm you are within range of the Receiver</p> <p>Confirm that the audio source selection of your amplifier is correct with your audio connection (Auxiliary audio)</p>

SPECIFICATIONS

Bluetooth version	Bluetooth V3.0
Bluetooth profiles	A2DP and AVRCP
Bluetooth frequency range	2.402GHz-2.480GHz
Operating distance	10 meters
Charging input voltage	DC 5V
Working time	12 hours
Charging time	2 hours

FCC STATEMENT

This device complies with part 15 of the FCC rules. Operation is subject to the following two conditions:

1. This device may not cause harmful interference, and
2. This device must accept any interference received, including interference that may cause undesired operation.



This class B digital apparatus complies with Canadian ICES-003.

WARNING:

This equipment has been tested and is found to comply with the limits for a Class B digital device, pursuant to Part 15 of the FCC Rules. These limits are designed to provide reasonable protection against harmful interference in a residential installation. This equipment generates, uses and can radiate radio frequency energy and, if not installed and used in accordance with the instructions, may cause harmful interference to radio communications. However, there is no guarantee that interference will not occur in a particular installation. If this equipment does cause harmful interference to radio or television reception, which can be determined by turning the equipment off and on, the user is encouraged to try to correct the interference by one or more of the following measures:

- Reorient or relocate the receiving antenna
- Increase the separation between the equipment and receiver
- Connect the equipment into an outlet on a circuit different from that to which the receiver is connected
- Consult the dealer or an experienced radio/TV technician for help

WARNING:

Changes or modifications not expressly approved by the party responsible for compliance with the FCC Rules could void the user's authority to operate this equipment.

ICC STATEMENT

Industry Canada Statement

This device complies with Industry Canada license-exempt RSS standard(s). Operation is subject to the following two conditions:

1. This device may not cause interference, and
2. This device must accept any interference, including interference that may cause undesired operation of the device.

SAFETY INFORMATION

Read all instructions.

Keep these instructions.

Heed all warnings.

Follow all instructions.

Do not use this apparatus near water.

Clean only with a dry cloth.

Do not block any ventilation openings. Install in accordance with the manufacturer's instructions.

Do not install near any heat sources such as radiators, heat registers, stoves, or other apparatus (including amplifiers) that produce heat.

Do not defeat the safety purpose of the polarized or grounding-type plug. A polarized plug has two blades with one wider than the other. A grounding type plug has two blades and a third grounding prong. The wide blade or the third prong are provided for your safety. If the provided plug does not fit into your outlet, consult an electrician for replacement of the obsolete outlet.

Protect the power cord from being walked on or pinched particularly at plugs, convenience receptacles, and the point where they exit from the apparatus.

Only use attachments/accessories specified by the manufacturer.

Unplug this apparatus during lightning storms or when unused for long periods of time.

Refer all servicing to qualified service personnel. Servicing is required when the apparatus has been damaged in any way, such as power-supply cord or plug is damaged. Liquid has been spilled or objects have fallen into the apparatus, the apparatus has been exposed to rain or moisture, does not operate normally, or has been dropped.

Apparatus shall not be exposed to dripping or splashing, and that no objects filled with liquids, such as vases, shall be placed on the apparatus.

The battery shall not be exposed to excessive heat such as sunshine, fire or the like.

The direct plug-in adapter is used as disconnect device, the disconnect device shall remain readily operable.

WARNING: The battery is recyclable. Batteries shall not be exposed to heat such areas.

WARNING: To reduce the risk of fire or electric shock, do not expose this apparatus to rain or moisture.



This marking indicates that this product should not be disposed with other household wastes throughout North America. To prevent possible harm to the environment or human health from uncontrolled waste disposal, recycle it responsibly to promote the sustainable reuse of material resources. To return your used device, please use the return and collection systems or contact the retailer where the product was purchased. They can take this product for environmental safe recycling.

WARRANTY

Thank you for choosing NYRIUS® Consumer Electronics Products!

NYRIUS gives the following express warranty to the original consumer purchaser or gift recipient for this NYRIUS product, when shipped in its original container and sold or distributed by NYRIUS or by an Authorized NYRIUS Dealer: NYRIUS warrants that this product is free, under normal use and maintenance, from any defects in material and workmanship. If any such defects should be found in this product within the applicable warranty period, NYRIUS shall, at its option, repair or replace the product as specified herein. Replacement parts furnished in connection with this warranty shall be warranted for a period equal to the unexpired portion of the original equipment warranty.

This warranty shall not apply to:

- A. Any defects caused or repairs required as a result of abusive operation, negligence, accident, improper installation or inappropriate use as outlined in the owner's manual.
- B. Any NYRIUS product tampered with, modified, adjusted or repaired by any party other than NYRIUS or NYRIUS's Authorized Service Centers.
- C. Damage caused or repairs required as a result of the use with items not specified or approved by NYRIUS including but not limited to head cleaning tapes and chemical cleaning agents.
- D. Any replacement of accessories, glassware, consumable or peripheral items required through normal use of the product including but not limited to earphones, remote controls, AC adapters, batteries, stylus, trays, filters, cables, paper, cabinet, cabinet parts, knobs, buttons, baskets, stands and shelves.
- E. Any cosmetic damage to the surface or exterior that has been defaced or caused by normal wear and tear.
- F. Any damage caused by external or environmental conditions, including but not limited to transmission line/power line voltage or liquid spillage.
- G. Any product received without appropriate model, serial number and CSA /cUL /cULus /cETL /cETLus markings.
- H. Any products used for rental or commercial purposes.
- I. Any installation, setup and/or programming charges.

Should this NYRIUS product fail to operate during the warranty period, warranty service may be obtained upon delivery of the NYRIUS product together with proof of purchase and a copy of this LIMITED WARRANTY statement to an Authorized NYRIUS Service Centre. In-home warranty service may be provided at NYRIUS discretion on any NYRIUS television with the screen size of 40" or larger. This warranty constitutes the entire express warranty granted by NYRIUS and no other dealer, service center or their agent or employee is authorized to extend, enlarge or transfer this warranty on behalf of NYRIUS. To the extent the law permits, NYRIUS disclaims any and all liability for direct or indirect damages or losses or for any incidental, special or consequential damages or loss of profits resulting from a defect in material or workmanship relating to the product, including damages for the loss of time or use of this NYRIUS product or the loss of information. The purchaser will be responsible for any removal, re-installation, transportation and insurance costs incurred. Correction of defects, in the manner and period of time described herein, constitute complete fulfillment of all obligations and responsibilities of NYRIUS Electronics to the purchaser with respect to the product and shall constitute full satisfaction of all claims, whether based on contract, negligence, strict liability or otherwise.

1 YEAR PARTS & LABOUR WARRANTY PERIOD

To obtain the name and address of the nearest authorized NYRIUS service center or for more information on this warranty contact NYRIUS support:

NYRIUS Customer Service
4080 Montrose Road, Niagara Falls, ON. L2H 1J9
nyrius.com/support

Nyrius is a registered trade-mark of Circus World Displays Limited