

# FLUANCE®

## Ai61 – Powered 6.5" Bookshelf Speakers

Quick Start Guide v1.2



## Important Safety Instructions

1. Read these instructions.
2. Keep these instructions.
3. Heed all warnings.
4. Follow all instructions.
5. Do not use this apparatus near water.
6. Clean only with dry cloth.
7. Do not block any ventilation openings. Install in accordance with the manufacturer's instructions.
8. Do not install near any heat sources such as radiators, heat registers, stoves, or other apparatus (including amplifiers) that produce heat.
9. Do not defeat the safety purpose of the polarized or grounding-type plug. A polarized plug has two blades with one wider than the other. A grounding type plug has two blades and a third grounding prong. The wide blade or the third prong are provided for your safety. If the provided plug does not fit into your outlet, consult an electrician for replacement of the obsolete outlet.
10. Protect the power cord from being walked on or pinched particularly at plugs, convenience receptacles, and the point where they exit from the apparatus.
11. Only use attachments/accessories specified by the manufacturer.
12. Use only with the cart, stand, tripod, bracket, or table specified by the manufacturer, or sold with the apparatus. When a cart is used, use caution when moving the cart / apparatus combination to avoid injury from tip-over.
13. Unplug this apparatus during lightning storms or when unused for long periods of time.
14. Refer all servicing to qualified service personnel. Servicing is required when the apparatus has been damaged in anyway, such as power supply cord or plug is damaged, liquid has been spilled or objects have fallen into the apparatus, the apparatus has been exposed to rain or moisture, does not operate normally, or has been dropped.
15. The use of apparatus in moderate climates.



### CAUTION

- Minimum 5cm around the apparatus for sufficient ventilation.
- The ventilation should not be impeded by covering the ventilation openings with items, such as newspapers, table-cloths, curtains, etc.
- No naked flame sources, such as lighted candles, should be placed on the apparatus.
- Should be drawn to the environmental aspects of the battery disposal.
- To reduce the risk of fire or electric shock, do not expose this apparatus to rain or moisture.
- Battery shall not be exposed to excessive heat such as sunshine, fire or the like.
- The mains plug or an appliance coupler is used as the disconnect device, the disconnect device shall remain readily operable.

## Précautions De Sécurité Importantes à Lire En Premier

1. Lisez ces instructions.
2. Conservez ces instructions.
3. Tenez compte de tous les avertissements.
4. Suivez toutes les instructions.
5. N'utilisez pas cet appareil près de l'eau.
6. Nettoyer uniquement avec un chiffon sec.
7. Ne bloquez aucune ouverture de ventilation. Installez conformément aux instructions du fabricant.
8. Ne pas installer à proximité de sources de chaleur telles que des radiateurs, des registres de chaleur, des poêles ou d'autres appareils (y compris des amplificateurs) qui produisent de la chaleur.
9. Ne détournez pas le but de sécurité de la prise polarisée ou de mise à la terre. Une fiche polarisée comporte deux pales dont une plus large que l'autre. Une fiche de type à la terre a deux lames et une troisième broche de mise à la terre. La lame large ou la troisième broche sont fournies pour votre sécurité. Si la fiche fournie ne rentre pas dans votre prise, consultez un électricien pour le remplacement de la sortie obsolète.
10. Protégez le cordon d'alimentation avant d'être piétiné ou pincé en particulier sur les bouchons, les prises de courant et le point où ils sortent de l'appareil.
11. N'utilisez que des accessoires / accessoires spécifiés par le fabricant.
12. Utilisez uniquement avec le chariot, le support, le trépied, le support ou la table spécifiés par le fabricant ou vendus avec l'appareil. Lorsqu'un chariot est utilisé, soyez prudent lorsque vous déplacez la combinaison panier / appareil pour éviter les blessures causées par le renversement.
13. Débranchez cet appareil pendant les orages ou lorsqu'il n'est pas utilisé pendant de longues périodes.
14. Référez tous les services à un personnel qualifié. Un entretien est nécessaire lorsque l'appareil a été endommagé de toute façon, comme le cordon d'alimentation ou la fiche est endommagée, le liquide a été renversé ou les objets sont tombés dans l'appareil, l'appareil a été exposé à la pluie ou à l'humidité, s'il ne fonctionne pas normalement ou s'il est tombé.
15. L'utilisation d'appareils dans les climats modérés.



### ATTENTION

- 5cm minimale autour de l'appareil pour une aération suffisante.
- il convient que l'aération ne soit pas gênée par l'obstruction des ouvertures d'aération par des objets tels que journaux, nappes, rideaux, etc...
- il convient de ne pas placer sur l'appareil de sources de flammes nues, telles que des bougies allumées.
- il convient d'attirer l'attention sur les problèmes d'environnement dus à la mise au déchet des piles
- le mode d'emploi doit stipuler que l'appareil ne doit pas être exposé à des égouttements d'eau ou des éclaboussures et de plus qu'aucun objet rempli de liquide tel que des vases ne doit être placé sur l'appareil.
- un avertissement selon lequel les batteries (bloc de batteries ou batteries installées) ne doivent pas être exposées à une chaleur excessive telle que celle du soleil, d'un feu ou d'origine similaire.
- lorsque la prise du RESEAU D'ALIMENTATION ou une prise placée sur l'appareil est utilisée comme appareil de déconnexion, cet appareil doit demeurer aisément accessible.

## Introduction

Thank you for your purchase of your Fluance product. We hope you enjoy your experience. If you have any questions please visit us at [www.Fluance.com/support](http://www.Fluance.com/support).

Fluance believes everyone should experience audio in its truest form, recreating the performance the way the artist intended. Utilizing only superior components and expert audio engineering, their products are a testament to the performance that can be achieved when a passion for music takes center stage. The perfect complement to any audiophile's lifestyle, you'll be enjoying live performances in your home for years to come.

## Break-in Period

Our speakers have a Butyl rubber ring surrounding the cone. The break-in period allows the rubber to loosen and stretch, allowing the cone a larger range of movement, resulting in better sound reproduction. We recommend 10-12 hours of play at moderate volume to achieve this.

For additional product information, please consult the manual at: [Fluance.com/resources](http://Fluance.com/resources)

## What's Included

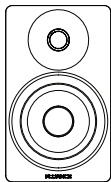

Ai61 Passive  
Speaker  
(Left Channel)

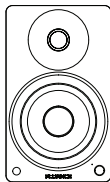

Ai61 Active  
Speaker  
(Right Channel)

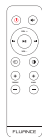

Remote  
Control



2x AAA  
Batteries

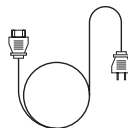

Power  
Cable



Speaker  
Wire

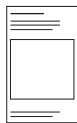

Quick Start  
Guide



Lifetime  
Customer Support



2 Year  
Warranty

## Front & Back Panel Layout

### 1. Control Knob

- Volume
- Input Selection
- Power ON/OFF

### 2. Source LED

- Blue (Solid) - Bluetooth® Paired
- Blue (Flashing) - Bluetooth® Pairing Mode
- Green (Solid) - RCA
- White (Solid) - Optical
- Purple (Solid) - USB
- Red (Solid) - Standby Mode
- Red (Flashing) - Mute
- Red (Flash x2) - Volume Set to Max
- Red (Flash x2) - Bass/Treb Set to -5 or +5
- Source Color: Blue/Green/White/Purple (Flash x2) - Bass/Treb Set to 0

### 3. IR Sensor

### 4. Speaker Input

### 5. Bluetooth® Reset Pairing

### 6. USB Input (Audio Playback Only)

### 7. Optical Input

### 8. RCA Input

### 9. Subwoofer Output

### 10. Left Speaker Output

### 11. AC Input

### 12. Power Switch

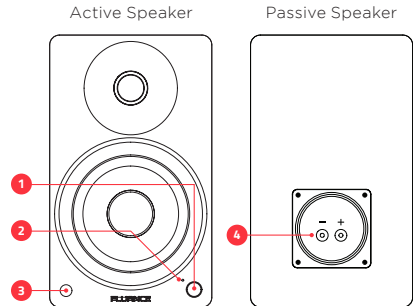

### Active Speaker (Back)

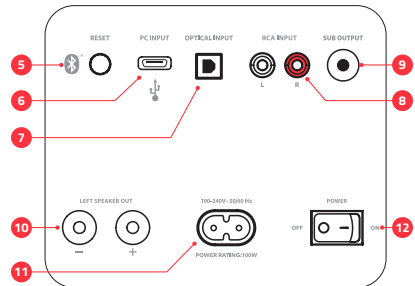

## Remote Control Layout

### 13. Power ON/OFF

### 14. Volume UP/DOWN

### 15. Source

### 16. Treble UP/DOWN

### 17. Mute

### 18. Play/Pause & Bluetooth® Pairing Reset\*

\*To enable Bluetooth® Pairing Reset, press + hold for 3 seconds.

### 19. Forward/Back

### 20. LED Brightness - (100% > 25% > OFF)

### 21. Bass UP/DOWN

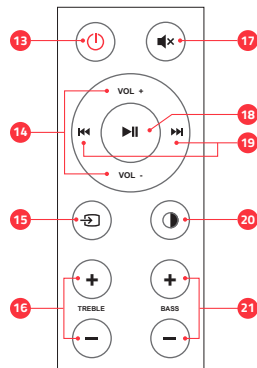

## Product Setup

1. Position the speakers with the Active Speaker on the right and the Passive Speaker on the left.

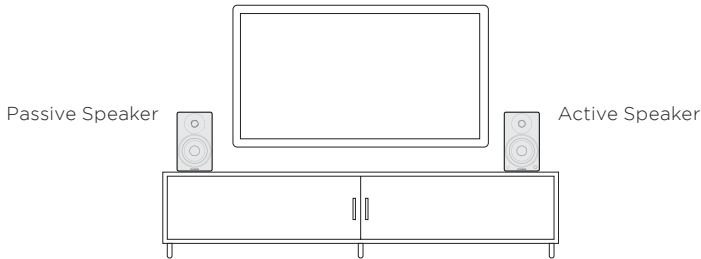

**NOTE:** If placing the speakers in a cabinet or on a shelf, position the front of the speakers as close as possible to the front edge of the shelf for optimum audio performance.

2. Connect one end of the speaker wire to the binding posts on the back of the Active Speaker and connect the other end of speaker wire to the binding posts on the back of the Passive Speaker.

***IMPORTANT:** Ensure the same wire is connected to the same color binding post on each speaker.*

**NOTE:** The included speaker wire is 8ft. If placing your speakers further than 8ft apart it is recommended to use standard 18 gauge speaker wire to connect the speakers over the longer distance.

3. Connect the power cable to the back of the Active Speaker and set the power switch to the ON position.

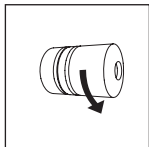

Loosen the binding post

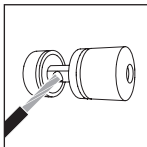

Insert speaker wire through hole

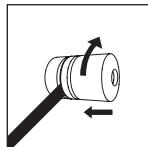

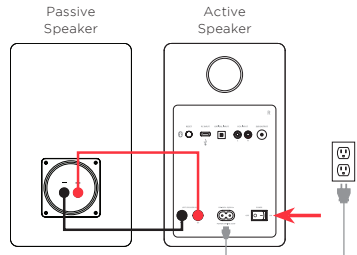

Tighten the binding post



## EQ Adjustment

Use the Bass/Treble buttons on the Remote to adjust each from -5 to +5.

LED Behavior:

-  Red (Flash 2x) - Bass/Treble Set to -5 or +5
-  Source Color (Flash 2x) - Bass/Treble Set to 0

Note: If using a source device, with it's own EQ settings, ensure it is set to flat(0).

## RCA Input

1. Connect the RCA cable to your source device (Turntable, Smartphone, Computer...).
2. Connect the other end of the RCA cable to back of the Active Speaker.

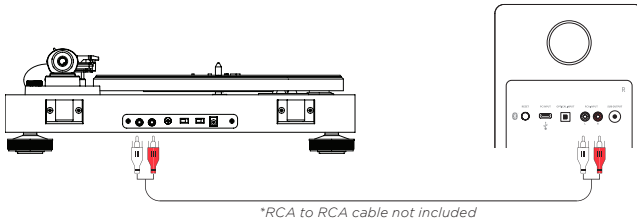

3. Press the Control Knob to select the RCA input (Green LED).
4. Adjust volume on Ai61 as well as source device.

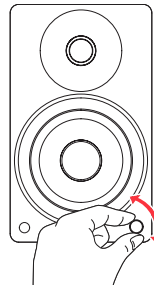
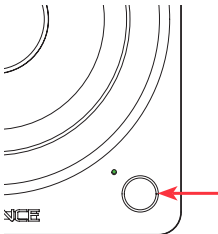

## Bluetooth® Pairing

1. Press the Control Knob to select the Bluetooth® input (Blue LED).

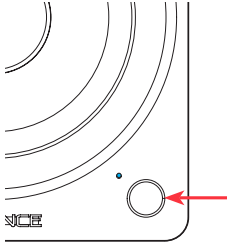

2. Pair to "Fluance Ai61" on your source device.

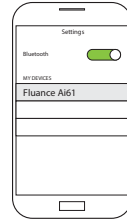

*Note: Unit will attempt to auto-pair to the last paired device.*

3. Use the Remote to control playback on your source device.

*Note: Adjust Volume on the source device as well as the Ai61.*



4. If your device cannot find "Fluance Ai61", you can reset Bluetooth® pairing.

- Press and hold **▶||** on the Remote for 3 seconds to reset Bluetooth® pairing.



- Press the Bluetooth® Pairing Reset Button on the back of the unit.

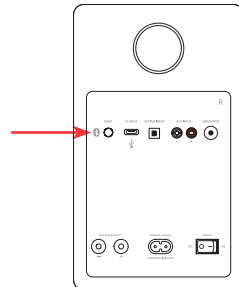

*Note: How you access your device's Bluetooth® settings may vary from one manufacturer to another. Maximum line of sight for Bluetooth® range is 33ft. Obstacles may decrease transmission distance.*

## Optical Input

1. Connect the Optical cable to your source device (TV, Computer, Game Console...). Ensure protective caps are removed from the ends of the Optical cable.
2. Connect the other end of the Optical cable to the back of the Active Speaker.

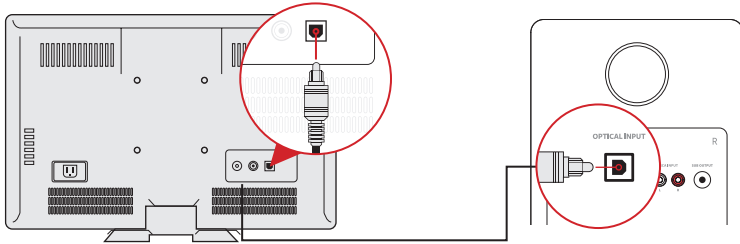

*\*Optical cable not included*

3. Press the Control Knob to select the Optical Input (White LED).
4. Adjust the volume on Ai61 as well as source device.

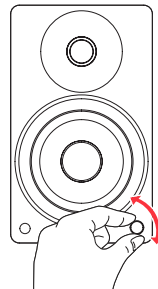
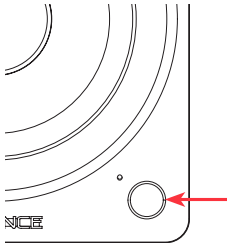

## Optical Audio Signal Compatibility

The Ai61 does not support Dolby Digital Audio or DTS Audio. Locate the audio output settings on your source device and ensure Dolby Digital is turned off. The correct audio output setting is commonly referred to as PCM or Stereo.

Some TVs also require that audio output be enabled. This setting may be referred to as External Speakers. Ensure this is selected as your speaker/audio output.

For instructions on a specific device, please consult the device's user manual.



## USB Input

1. Connect the USB cable to your source device (Laptop, Desktop...).
2. Connect the other end of the USB cable to the USB C port on the back of the Active Speaker.

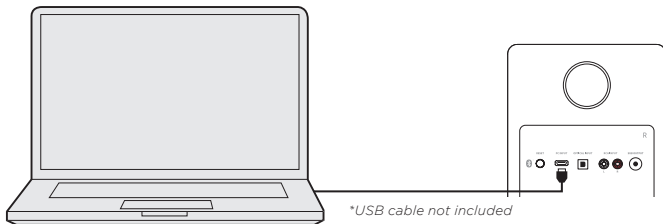

*IMPORTANT: The USB input on the Ai61 is for USB audio playback and not for USB charging.*

3. Press the Control Knob to select the USB Input (Purple LED).
4. Adjust the volume on Ai61 as well as source device. You may also need to adjust volume in the different programs on the source device.

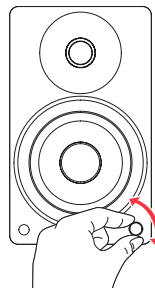
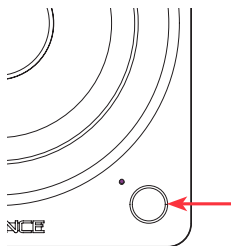

## USB Audio Output Settings

You may need to enable USB audio output on your source device. Here are the directions for most Windows® and Apple® Computers.

Windows®: Control Panel > Sound > USB Audio

Apple®: System Preferences > Sound > Output > USB

It is also important to check that any sound enhancements, effects, or EQ settings are disabled on your source device.

## Subwoofer Output

*IMPORTANT: When a subwoofer cable is connected, the Ai61 will automatically cut frequencies below 80Hz to optimize performance. The subwoofer cable must be removed to resume full frequency playback.*

1. Connect the Subwoofer cable to your powered subwoofer.
2. Connect the other end of the Subwoofer cable to the back of the Active Speaker.
3. Adjust the volume on the Subwoofer for the best listening experience.

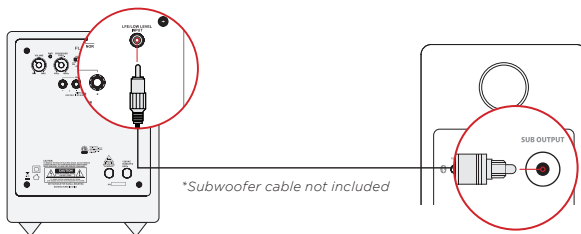

Fluance offers matching subwoofers for the ultimate audio experience. For more information visit: [www.Fluance.com/subwoofer](http://www.Fluance.com/subwoofer).

## Frequently Asked Questions

### What is “auto-pairing” and how does it work?

Auto-pairing is a convenient connection feature included in all Fluance Bluetooth® Speakers. If the connected Bluetooth®-enabled device leaves the connection range of the Ai61 and returns at a later time, the device will automatically connect. If the device's Bluetooth® function is disabled and then enabled at a later time, the device will automatically connect as well.

\*Note: The Fluance Ai61 will only auto-pair to the last device that it was connected to.

### Another device is connected to my Fluance Ai61 and I want to connect my device.

You can reset any Bluetooth® connection by pressing the Bluetooth® Pairing Reset button on the back of the Active Speaker. You can also press and hold “Play/Pause” on the Remote for 3 seconds.

### How can I increase the volume when using the Ai61 with a turntable?

If turntable audio is too quiet you may need to add a preamplifier. Some turntables have built in preamps which can be turned on or off. The Fluance PA10 preamplifier is a great match for Fluance powered speakers and turntables.

### Why is the volume from each input different on the Ai61?

Ensure that any volume and EQ settings on your source devices are set to similar levels. The different signal types used by each input means they are processed differently by the Ai61. The Optical Input uses a digital signal while the RCA Input uses an analog signal. These differences can result in slight variances in the output volume of the Ai61.

## Certification Information

### FCC Statement

This equipment has been tested and found to comply with the limits for a Class B digital device, pursuant to Part 15 of the FCC Rules. These limits are designed to provide reasonable protection against harmful interference in a residential installation. This equipment generates uses and can radiate radio frequency energy and, if not installed and used in accordance with the instructions, may cause harmful interference to radio communications. However, there is no guarantee that interference will not occur in a particular installation. If this equipment does cause harmful interference to radio or television reception, which can be determined by turning the equipment off and on, the user is encouraged to try to correct the interference by one or more of the following measures:

- Reorient or relocate the receiving antenna.
- Increase the separation between the equipment and receiver.
- Connect the equipment into an outlet on a circuit different from that to which the receiver is connected.
- Consult the dealer or an experienced radio/TV technician for help.

This device complies with part 15 of the FCC Rules. Operation is subject to the following two conditions: (1) This device may not cause harmful interference, and (2) this device must accept any interference received, including interference that may cause undesired operation. Changes or modifications not expressly approved by the party responsible for compliance could void the user's authority to operate the equipment. This equipment complies with FCC radiation exposure limits set forth for an uncontrolled environment. This equipment should be installed and operated with minimum distance 20cm between the radiator & your body. The device has been evaluated to meet general RF exposure requirement. The device can be used in portable exposure condition without restriction.

### IC Warning

This device complies with Industry Canada license-exempt RSS standard(s).

Operation is subject to the following two conditions:

(1) This device may not cause interference, and (2) This device must accept any interference, including interference that may cause undesired operation of the device.

Le présent appareil est conforme aux CNR d'Industrie Canada applicables aux appareils radio exempts de licence. L'exploitation est autorisée aux deux conditions suivantes:

(1) l'appareil ne doit pas produire de brouillage, et

(2) l'utilisateur de l'appareil doit accepter tout brouillage radioélectrique subi, même si le brouillage est susceptible d'en compromettre le fonctionnement.

Changes or modifications not expressly approved by the party responsible for compliance could void the user's authority to operate the equipment. This equipment complies with IC radiation exposure limits set forth for an uncontrolled environment. This equipment should be installed and operated with minimum distance 20cm between the radiator & your body. This transmitter must not be co-located or operating in conjunction with any other antenna or transmitter.

# Warranty Information

Thank you for choosing Fluance! We guarantee your investment in our products is a solid one. High performance components combined with quality craftsmanship allow us to maintain the highest possible production standards. All items are guaranteed against defects in materials and craftsmanship. Fluance has outstanding quality control; if something should go wrong with any of our products, we will repair it free of charge within the warranty period. If the product cannot be repaired, we will replace the product. If the product has been discontinued, we will replace the product with either the newest version of said product or current equivalent. In the event that Fluance replaces a product under warranty, the replacement would only carry the original warranty from the original date of purchase.

## Warranty Period

The Fluance products below are warrantied for parts and labor for the stated period from date of original purchase, and are subject to the terms and conditions of the warranty. Any refurbished products that are discontinued hold a 90 day warranty from the date of original purchase. Fluance warranties are valid for the original owner and are non-transferable.

Home Audio Passive Speakers: Lifetime Warranty  
Active/Powered Speakers: Two Year Warranty  
HiFi Turntables: Two Year Warranty  
Batteries (For Powered Speakers): One Year Warranty

## Warranty Exclusions

- Products purchased from a dealer not authorized by Fluance.
- Products with the serial number defaced, altered, or missing.
- Defects resulting from disaster, accident, abuse, misuse, lightning, power surges, neglect, unauthorized modification or water damage.
- Defect or damage as a result of repairs performed by a person or party not authorized by Fluance.
- Defects of damage occurring during shipping (claims should be made with the shipping company).
- Defect or damage as a result of connecting a product to an outlet with the incorrect voltage. Voltage converters must be used where applicable.
- Consumable parts including, but not limited to, batteries, styli, and rubber belts.

## To Obtain Warranty Service

Should your product require warranty service, please contact us at [www.fluance.com/contact](http://www.fluance.com/contact) or call us at 1-888-617-6863 to set up a Return Authorization. Products returned without a valid Return Authorization number will be refused.

Fluance products must be returned in their original packaging. Our products are packaged specially to protect them from any damage during shipping, and without this packaging the return shipment could get damaged.

This warranty does not cover the shipping cost, insurance, or any other incidental charges. Products shipped for warranty service must be pre-paid by the customer, and Fluance will cover the cost to ship the repaired or replaced product back to the customer.

---

Thank you for your purchase of this Fluance® product.  
We hope you enjoy your experience.

Questions?  
Give us a chance to help, we're just a click away.



[Fluance.com/resources](http://Fluance.com/resources)



[Fluance.com/support](http://Fluance.com/support)



[Fluance.com/videos](http://Fluance.com/videos)



[Fluance.com/contact](http://Fluance.com/contact)

Don't forget to register your product with us!  
[Fluance.com/registration](http://Fluance.com/registration)